

CPT GROUP JOINT STOCK COMPANY



# CPT STEEL

---

PRE-ENGINEERED STEEL BUILDINGS

---



*Joint Development - Joint Success*

# CONTENTS

## 01

Open letter  
Introduction  
Vision, mission, and core values  
History  
CPT STEEL's Differences

---

## 02

CPT STEEL products  
Human capacity  
Company profile  
Production equipment  
Labor safety

---

## 03

Customers and partners  
Letter of assessment  
Certificate of Quality  
Implemented projects

## Open letter

### Dear Partners and Customers

CPT GROUP JSC would like to send to partners and customers the most respectful greetings

Along with the development and integration of the Vietnam's economy and larger region's, the industrial construction is also developing. Capital flows of domestic and foreign investors (FDI) are being continuously invested in Vietnam and the region

CPT STEEL, with 15 years of establishment and development, is a professional contractor in the field of steel structures and covering roofing sheets from the stages of "DESIGN, CONSULTATION, FABRICATION, and INSTALLATION. We have dedicated, responsible, dynamic, professional, and high-quality staff, who are always ready to devote for work and for green and sustainable development, and three plants with the capacity of 8,000 tons/month, which are applied with the quality management system ISO 9001: 2015, ISO 14001:2015, ISO 45001:2015. When carrying out projects, the criteria of SAFETY, QUALITY, SCHEDULE, OPTIMAL SOLUTION, AND COMPETITIVE PRICE are strictly maintained and observed.

The guiding principle in cooperation with partners and customers is being always APPRECIATED BY partners and customers. With years of experience in completing projects that have been highly appreciated and trusted by prestigious domestic and foreign partners and customers, a number of partners have signed strategic cooperation agreements with CPT STEEL.

CPT STEEL is looking forward to working with our partners and customers on suitable projects in order to bring the highest value to the parties and contribute to the green and sustainable development of the economy of Vietnam and the region. We our partners and customers growth and success!

Best regards,

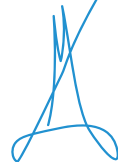

**Nguyen Manh Ha**  
Chairman of the Board





## CPT GROUP JOINT STOCK COMPANY

**We are one of the leading companies in the field of designing, manufacturing, and supplying pre-engineered steel buildings in Vietnam**

With our method of supplying lump-sum services of Design, Fabrication, and Installation of steel structures in general, and pre-engineered steel buildings in particular, we have focused on resources from quality personnel to modern and closed production lines to confidently provide customers with the best solutions for projects to optimize investment costs and quality. Currently, CPT STEEL is able to meet all the demands of designing, manufacturing, and installing steel structures for workshops, warehouses, restaurants, and pre-engineered buildings.

The brand name CPT STEEL has been associated with hundreds of large and small projects in both size and value across the country, which have been recognized and appreciated by customers for the quality and services provided. CPT STEEL is currently a close and long-term partner of domestic and foreign customers.

Focusing on quality to meet the strictest requirements of customers, CPT STEEL has applied the quality management system ISO 9001: 2015, ISO 14001:2015, ISO 45001:2015. so as to satisfy all the toughest investors from places/ countries such as Japan, Korea, Taiwan, Malaysia, Singapore, Hong Kong, The Czech Republic, and Vietnam,...

“Competitive price, good service quality, and guaranteed schedule” is our motto.

### Company information

Vietnamese company's name:	CÔNG TY CỔ PHẦN CPT GROUP
Business type:	JOINT STOCK COMPANY
Transaction name in English:	CPT GROUP JOINT STOCK COMPANY
Abbreviated name:	CPT GROUP
Ha Noi Head office:	Kim Anh Building, No 1/78 Duy Tan Street, Ha Noi City
Ho Chi Minh Head office:	No 56 Yen The Street, Ho Chi Minh City
Factory No.1:	Hiep Hoa Industrial Cluster, Hiep Hoa District, Bac Giang Province
Factory No.2:	Thang Town, Hiep Hoa District, Bac Giang Province
Factory No.3:	Thanh Van Industrial Cluster, Hiep Hoa District, Bac Giang Province
Website:	www.cptsteel.com





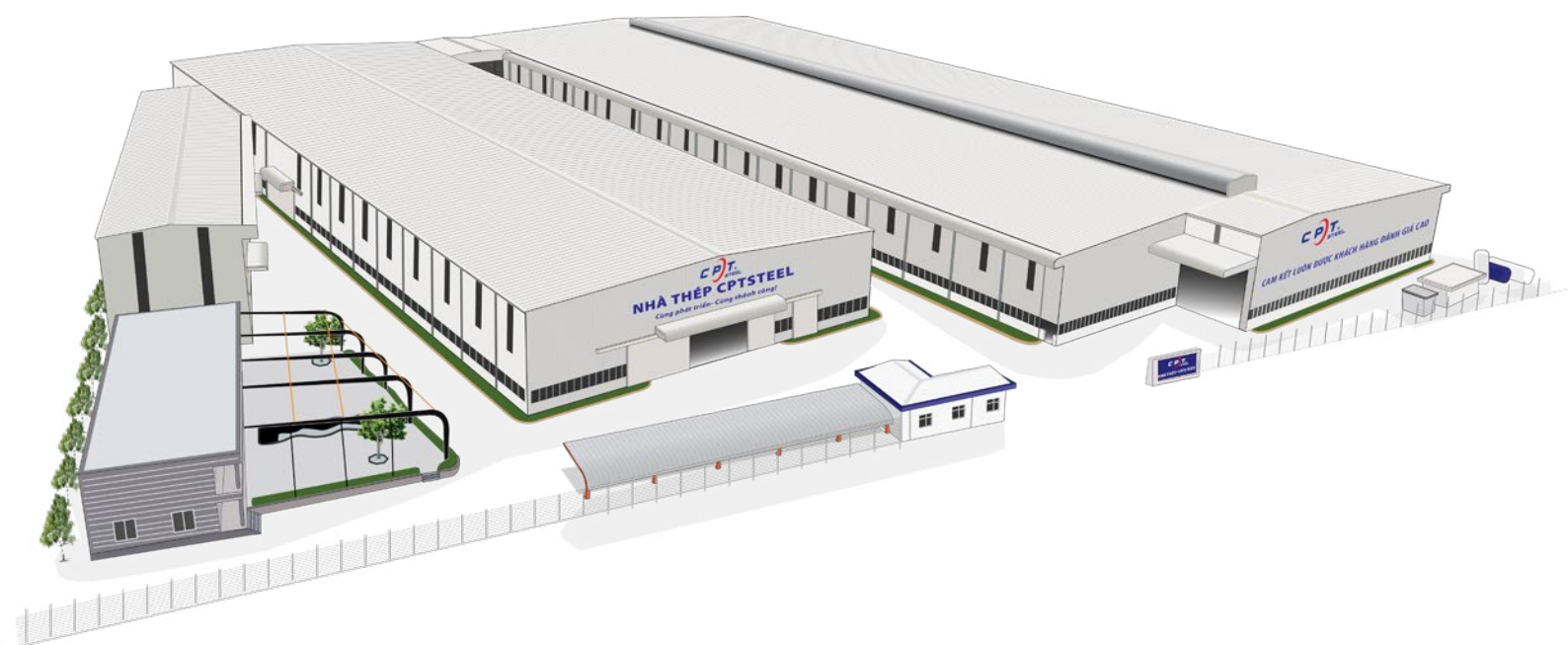

## Vision

With pioneer aspirations and a focus on strong investment in human resources and the technology and machinery systems, we strive to be a leading and prestigious company in the field of pre-engineered steel buildings in Vietnam by 2025 to create high-quality products and raise the position of Vietnam steel structure businesses in the eyes of partners

## Mission

Become a reliable steel structure supplier who is the first choice of all customers thanks to the ability to provide a full range of products and services with high-standard quality and focus on customers as the core for development

Building the best working environment for all employees of the company to create opportunities for the development of ability to contribute values to the business and society then create a good and full life for all employees and their families

Provide shareholders with sustainable and effective benefits based on sound business development strategies and rigorous risk management

## Core values

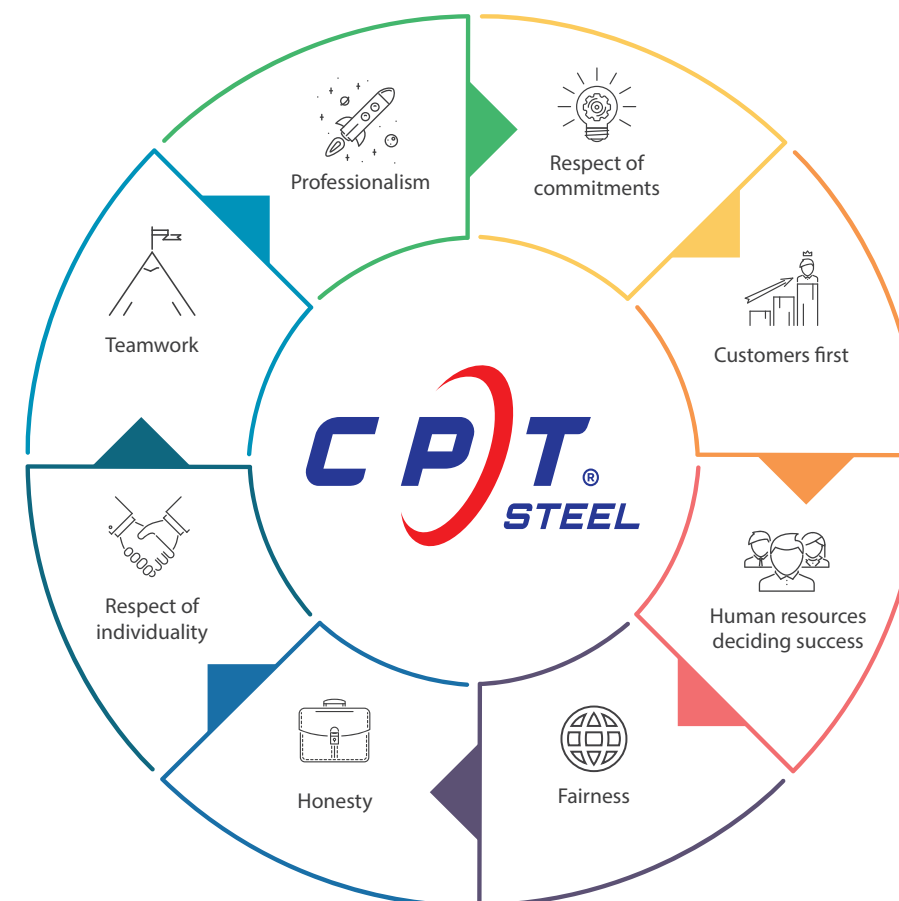

### Professionalism

The team of highly qualified staff have a professional and dedicated manners & behavior to ensure the success of the CPT STEEL brand.

### Respect of commitments

CPT STEEL has always seriously implemented its commitments, including internal commitments and commitments to customers

### Customers first

Customer satisfaction is the goal for all our activities

### Respect of individuality

Employees have always been given the maximum opportunities to promote their capacity, develop themselves, and succeed with the company. They have always been listened to and advised by their colleagues regardless of their positions. They dare to speak straight and share their thoughts and views in the spirit of mutual respect, fairness and equality in every situation

### Fairness

CPT STEEL has always treated employees, customers, suppliers, and stakeholders fairly.

### Honesty

CPT STEEL has always emphasized honesty in relationships and transactions with customers and suppliers

### Human resources deciding success

Human resources are the central development element affecting success or failure. Therefore, CPT STEEL has always focused on investing in training and development of human resources.

### Teamwork

There are common beliefs and goals for the development of the company without jealousy, malice, detestation, and factions. People help, support, show concern, and treat each other like brothers

# HISTORY

## 2007

Establishment of CPT Vietnam Mechanical Construction JSC; Completion and commencement of the steel structure factory with a capacity of 300 tons/month.

## 2010

Expansion of the working office and investment in upgrading the production line of the factory, raising the capacity to 500 tons / month.

## 2012

Official opening of the company's representative office in Hanoi

## 2015

Adoption of the investment policy to build the factory to meet the increasing demand of the market; construction of factory No.2 was officially commenced on an area of 3.5 hectares in November

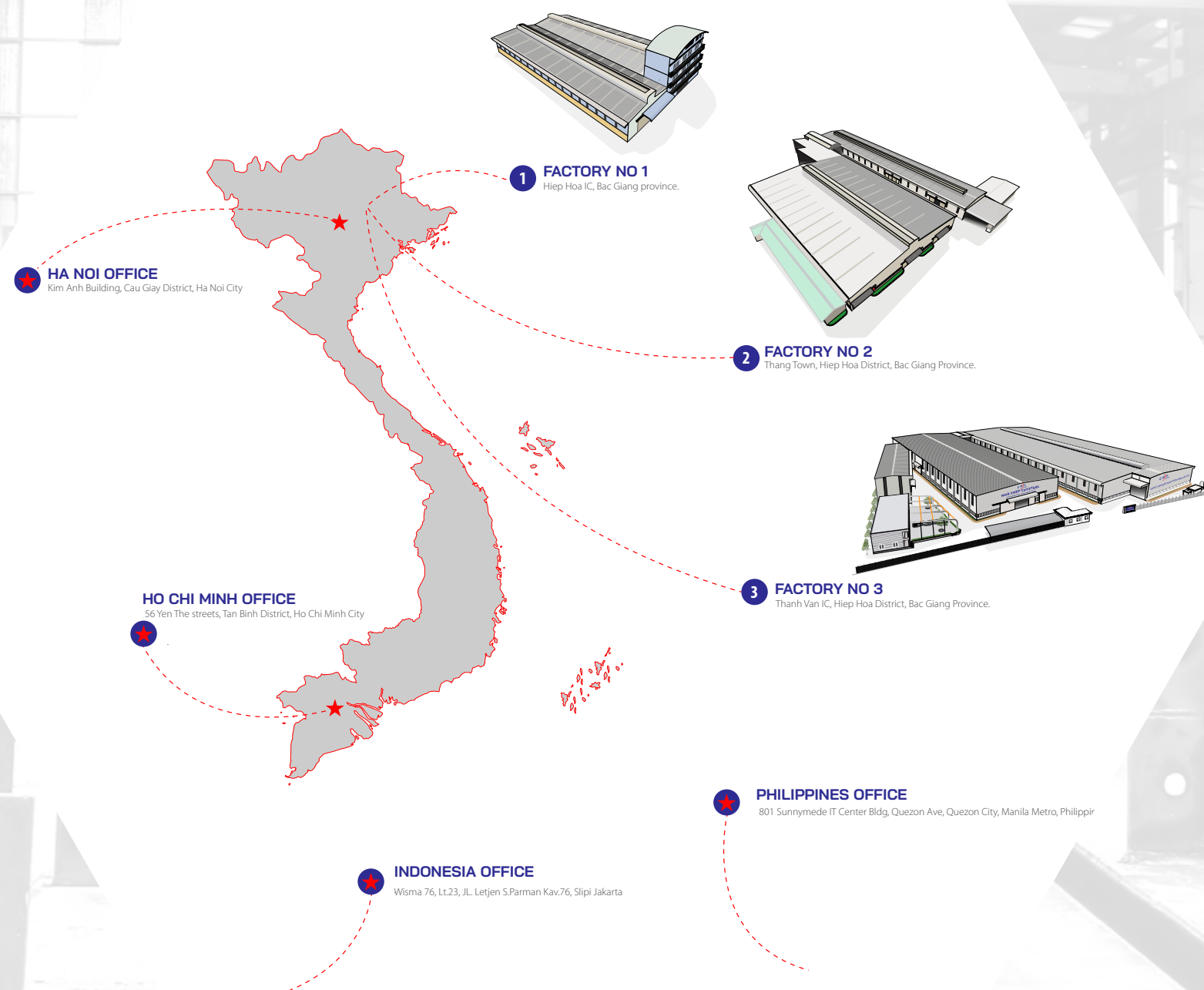

## 2016

Completion and commencement of the steel structure factory No. 02 with a comprehensively modern and highly automatic production line.  
Workshop area: 20,000 m<sup>2</sup>  
Capacity: 1,300 tons/month  
Total investment: VND 80 billion

## 2021

Official opening of the company's representative office in Ho Chi Minh City and Over Sea office in Philippines and Indonesia, increase export ratio.

## 2022

Completion and commencement of the steel structure factory No. 03. total capitor CPTSTEEL a 8.000 tons/ month.  
Conversion of CPT Vietnam Mechanical Construction JSC to CPT Group JSC.

...









We recognize that investing in self-development and human development can bring about sustainable values in the long run. With a solid orientation and accumulated and constantly improved production line system and production technology, we have equipped our staff with a solid knowledge base, keen occupational thinking, and a spirit of non-stop practice, application, and self-development right down to the smallest daily task to reach the goal of making the biggest difference from the factory to the site, making the most cost-effective, high-quality products for our customers



**CPT<sup>®</sup>**  
**STEEL**



### DESIGN

All creative and coordination efforts in design and consultation are to provide the best solutions. With a creative, experienced, and dedicated team of designers, CPT STEEL is proud to bring hundreds of customers the optimal designs in the field of pre-engineered steel buildings



### MANUFACTURING

With a modern production line and experienced, skilled, and well-trained stars, CPT STEEL will always bring high-quality products to customers



### CONSTRUCTION

Labour safety is always a priority of CPT STEEL. The Company engineers and erection workers have been regularly trained in the field of labour safety



### WARRANTY SERVICES.

Not only does the warranty service help minimize risks and incidents, but it also enhances the value and trust of the construction project. CPT STEEL is committed to quality and professional services. The warranty service plays a crucial role in building long-term relationships and fostering trust with our customers.



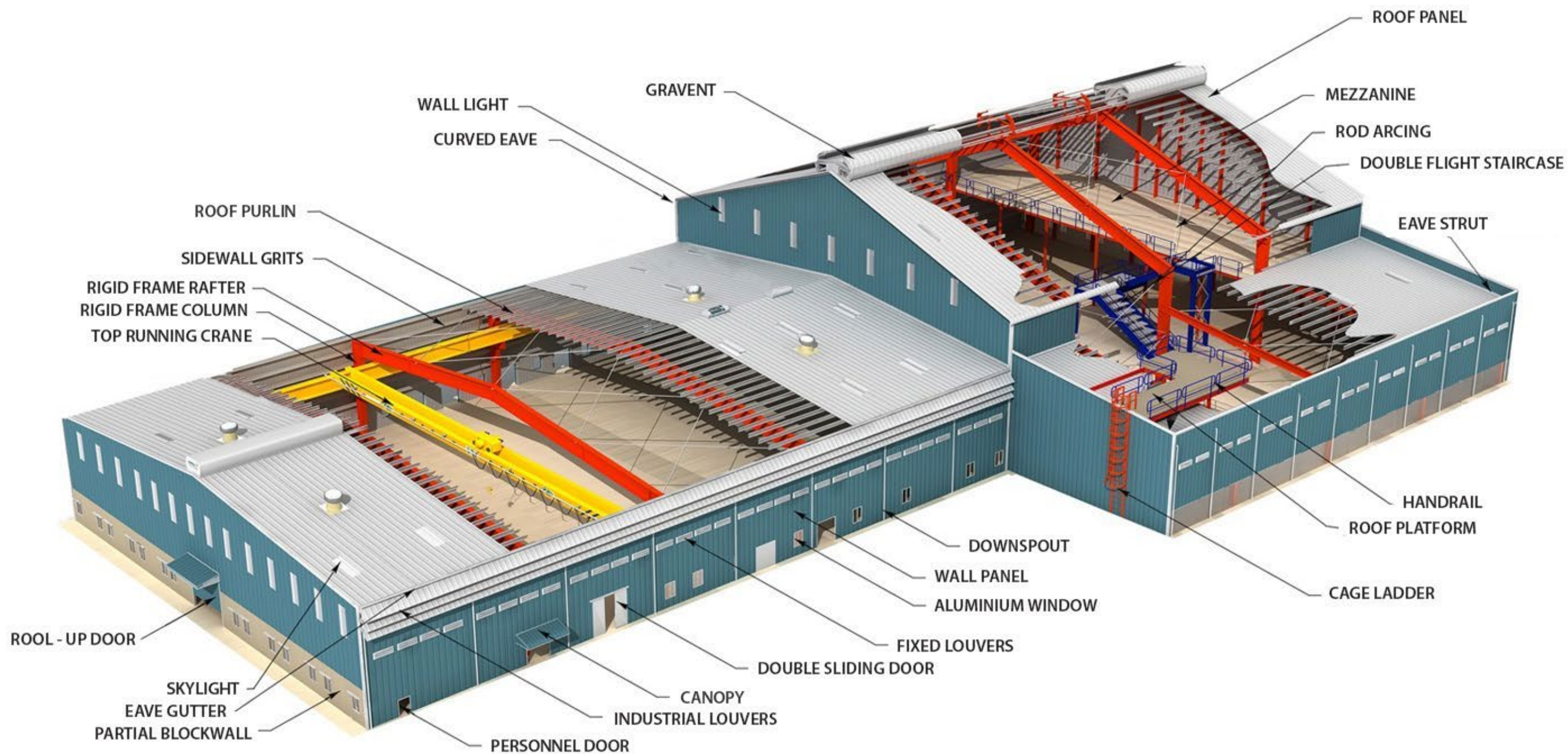

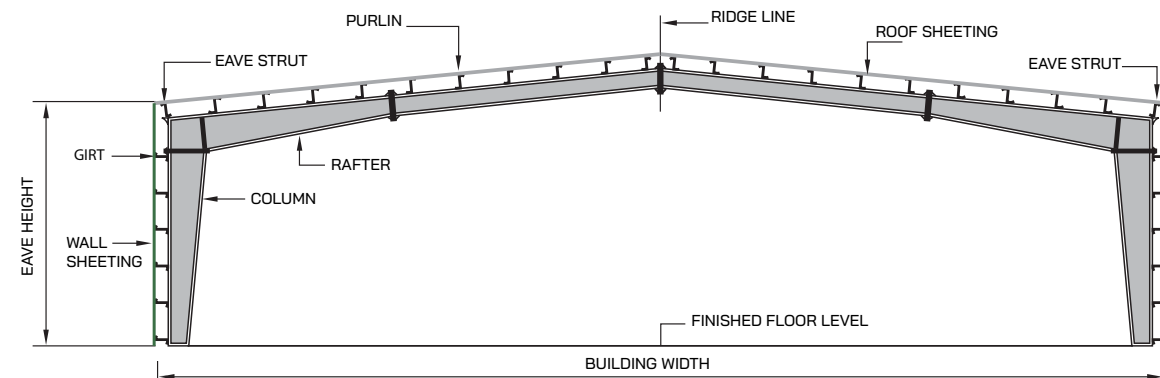

Typical Cross Section

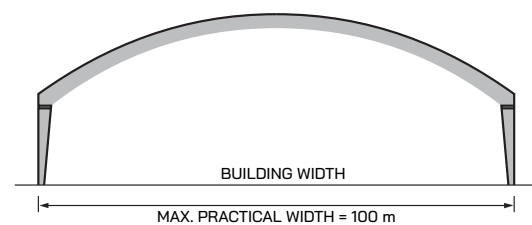

Built-up Curved Rafter (BU)

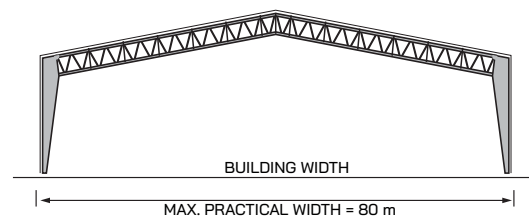

Hybrid

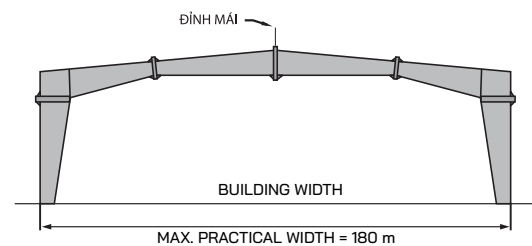

Clear Span (CS)

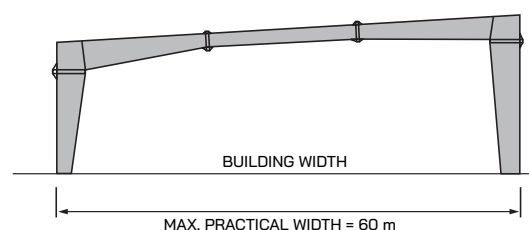

Single Slope (SS)

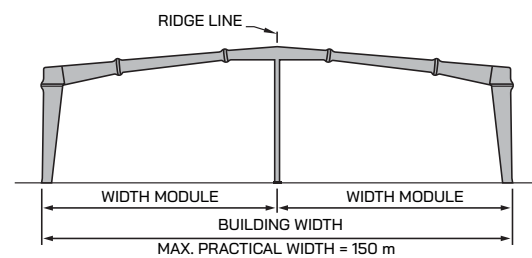

Multi-Span "1" (MS-1)

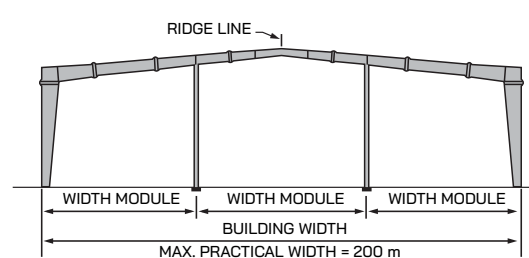

Multi-Span "2" (MS-2)

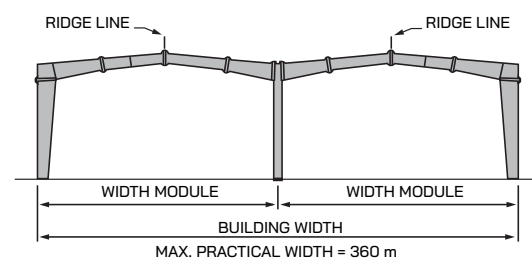

Multi-Gable (MG)

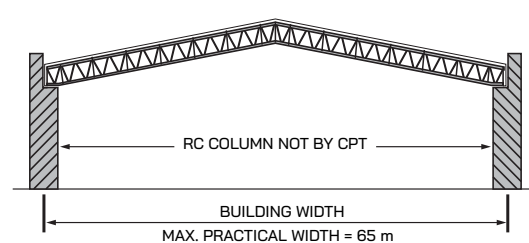

Roof System (RS)

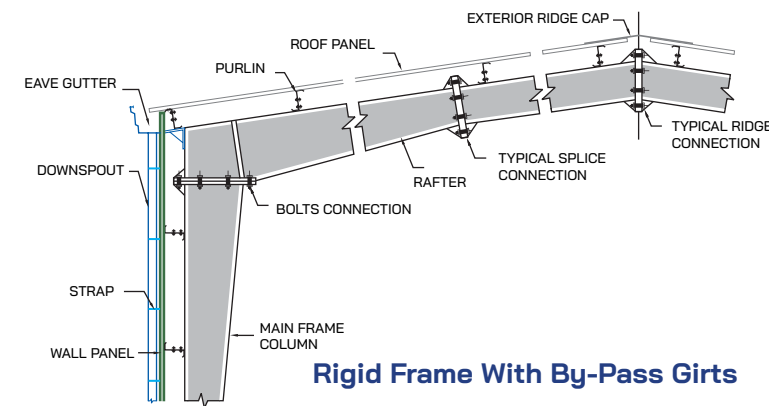

Rigid Frame With By-Pass Girts

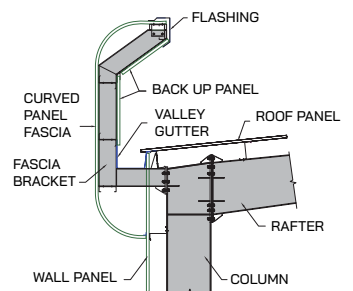

Curved Fascia

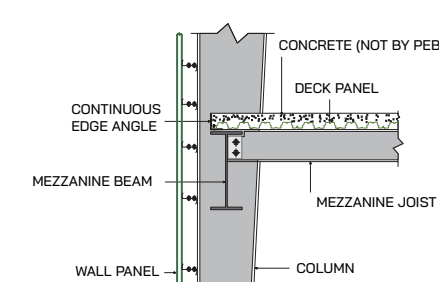

Mezzanine Joist Connection to Mezzanine Beam

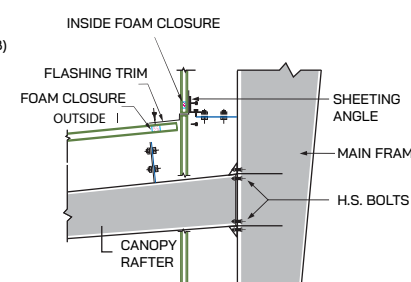

Canopy

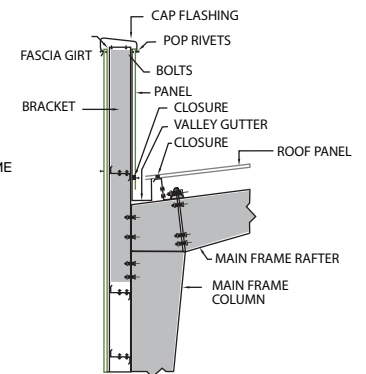

Parapet Fascia

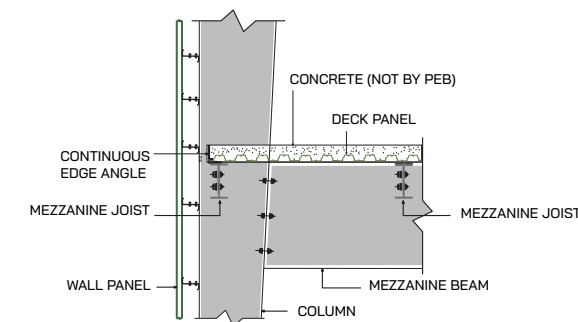

Mezzanine Beam Connection to Main Frame Column

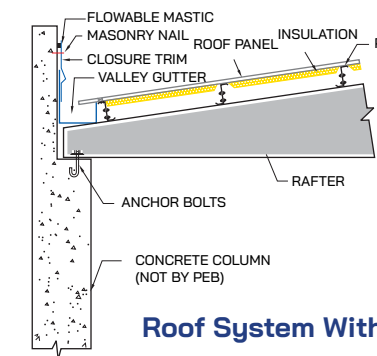

Roof System With Insulation

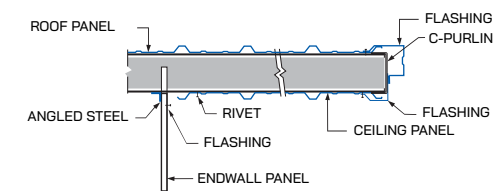

Endwall Roof Extension With Soffit

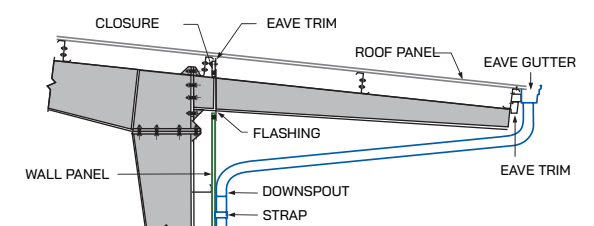

Sidewall Roof Extension



CPT STEEL Pre-Engineered Steel Buildings - The best solution for your project. If a project needs cost savings, quick installation, and absolute and sustainable quality control, CPT STEEL pre-engineered steel buildings are the best choice. Pre-Engineered Steel Buildings are the latest construction trend in the world. Pre-engineered steel buildings are increasingly asserting outstanding advantages in the field of industrial and civil construction such as factories, warehouses, high-rise buildings, showrooms, heavy industry, or infrastructure ...

### High-rise structure



### Workshop structure

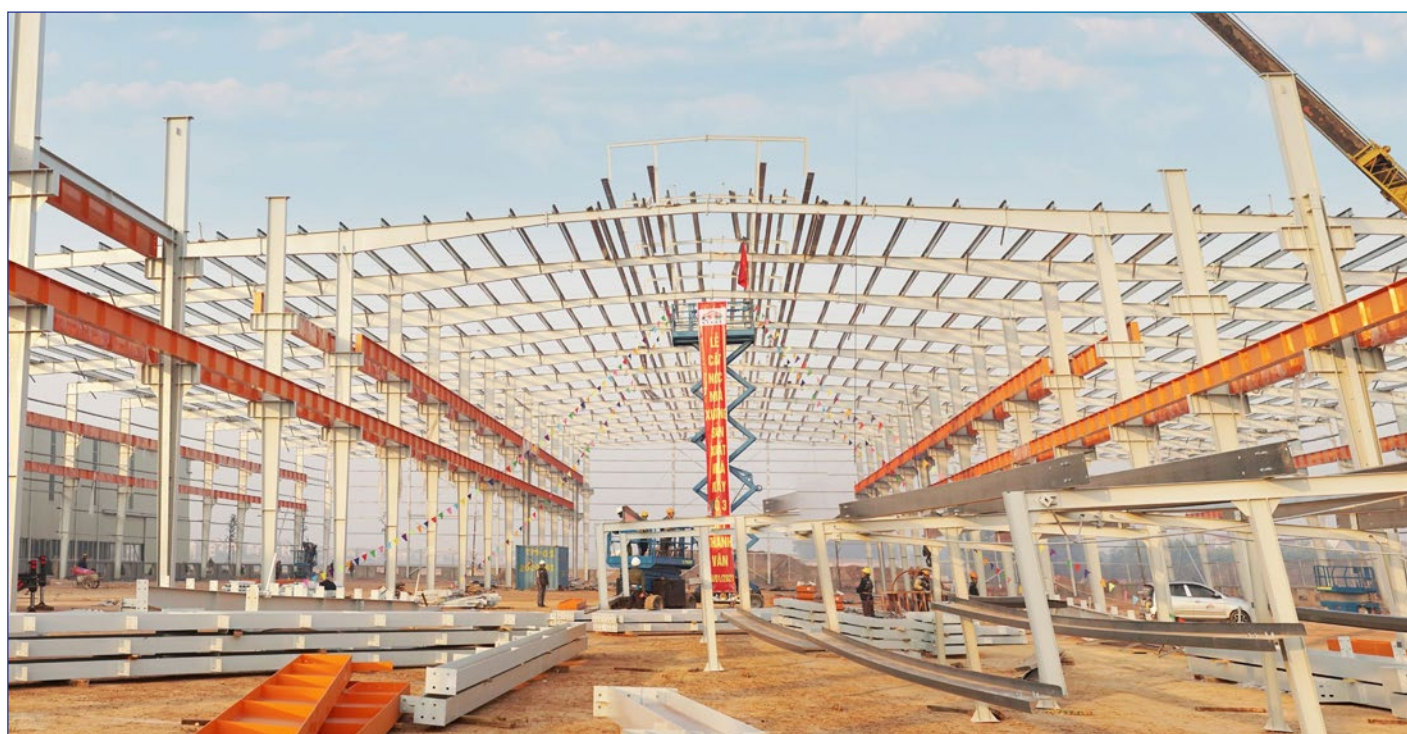

### High tower structure



### Pipe Rack System





## Decking

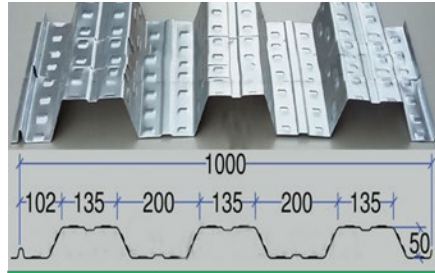

Decking H =50

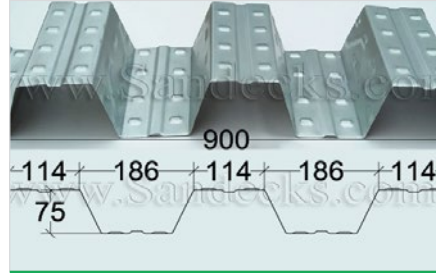

Decking H =75



Speed Decking

## Purlin

CPT STEEL supplies purlins from normal strength to high strength with galvanization Z80 - Z275

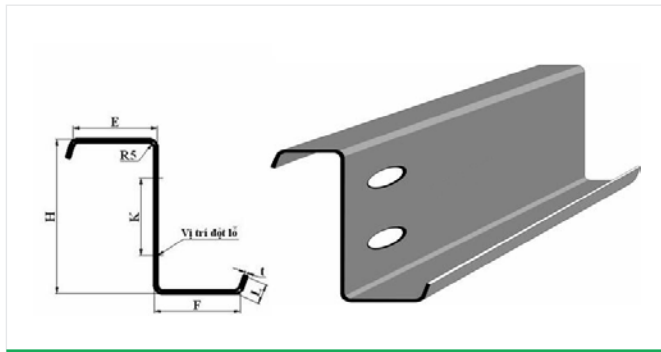

Z Purlin

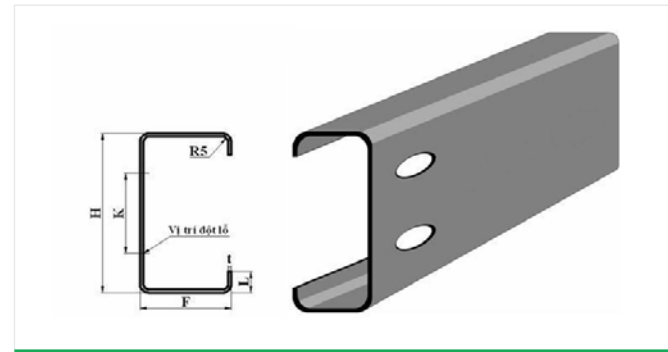

C Purlin

## Overhead Crane

CPT STEEL is currently developing and supplying various types of overhead cranes

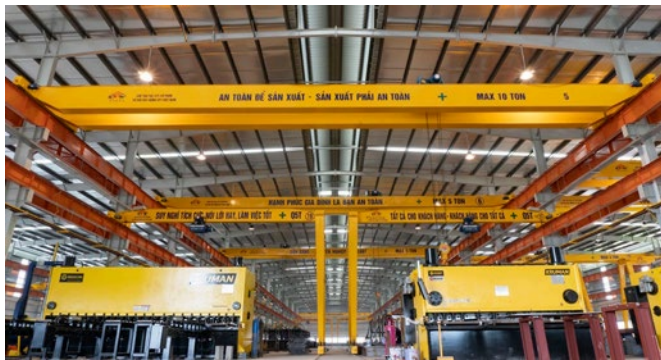

crane modul



crane quality check

## THERMAL INSULATION COVERING MATERIALS

Currently, CPT STEEL provides a full range of solutions for covering materials to industrial factories

## Steel panel



05 (06) ribs Steel Panel

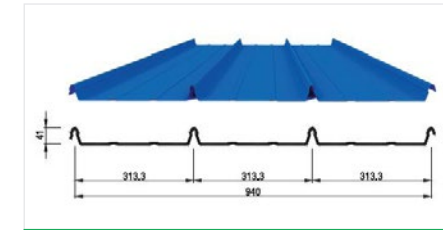

Kliplock Steel Panel

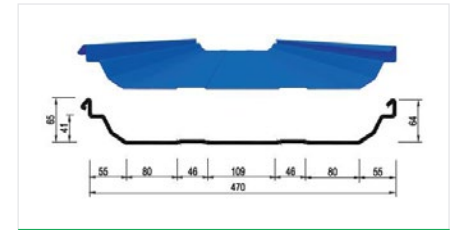

Seamlok Steel Panel

## Insulating materials

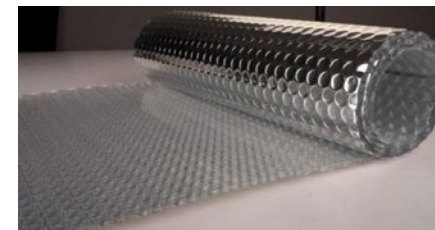

Air-bag insulation



Glass wool insulation



Rockwool

## Insulation panel



EPS/PU Sandwich panel - 3 layers

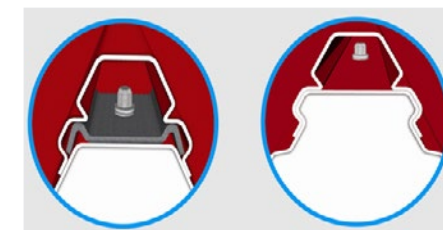

Screw cap for roof panel

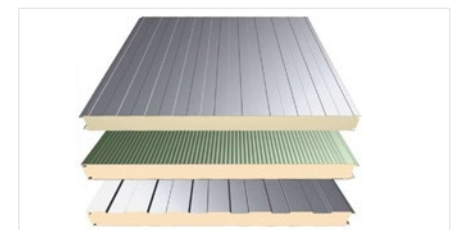

Sandwich panel

## Supplier partner







People are the core and decisive element in all CPT STEEL's activities. Therefore, at CPT STEEL, we are determined to build a team of experienced, qualified workers who always have the spirit of the highest responsibility and professionalism

In the process of formation and development, despite many difficulties and challenges, CPT STEEL, as a family, constantly researches techniques and improves skills and production capacity towards the goal of becoming one of the strongest enterprises in the domestic and international markets.

### Human resources diagram

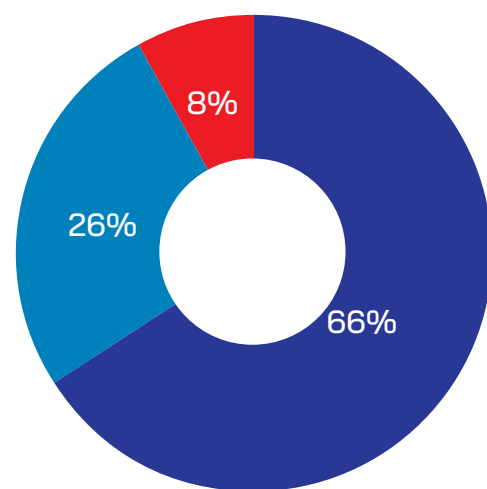

#### Cơ cấu nhân sự

- Leaders and Managers: 8 %
- Engineers: 26 %
- Workers : 66 %

### Organizational chart

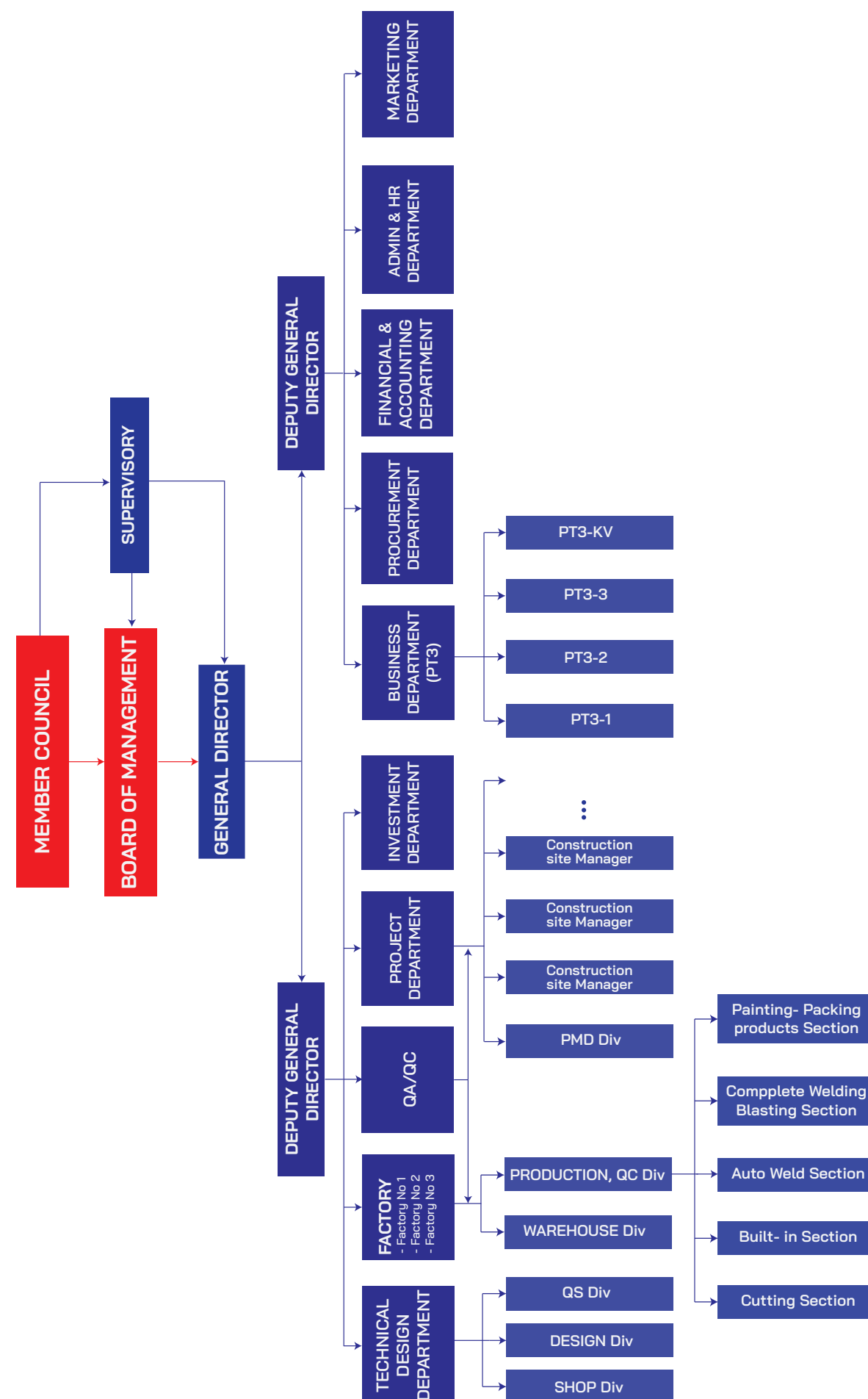



CPT STEEL HAS THREE FACTORIES WITH TOTAL AREA OF OVER 7 HA. THE TOTAL PRODUCTIVITY OF THE FACTORIES IS UP TO 8,000 TONS/MONTH. THE FACTORIES HAVE MORE THAN 500 EXPERIENCED, QUALIFIED, AND WELL-TRAINED EMPLOYEES.







### FACTORY NO 1

- Construction area: 10.000 m<sup>2</sup>
- Capacity: 1.200 tons/month.



### FACTORY NO 2

- Construction area: 35.000 m<sup>2</sup>
- Capacity: 2.600 tons/month.



### FACTORY NO 3

- Construction area: 30.000 m<sup>2</sup>
- Capacity: 4.200 tons/month.



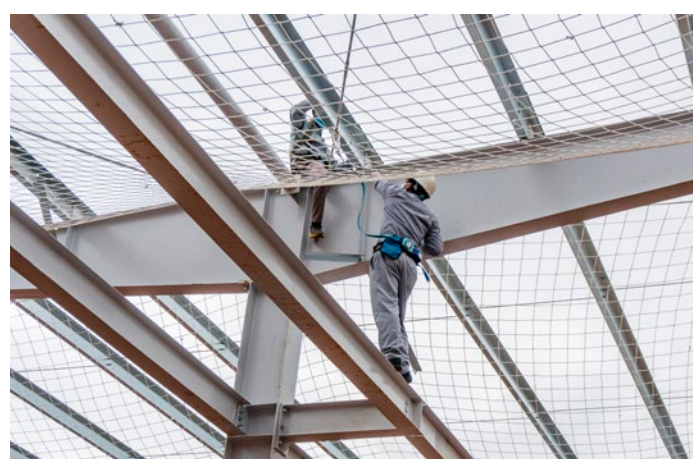



At CPT STEEL, equipment is always modernized. Products manufactured by modern and closed production lines from the processing of raw materials to finished products are processed by an imported machine system with high-precision and high-capacity.

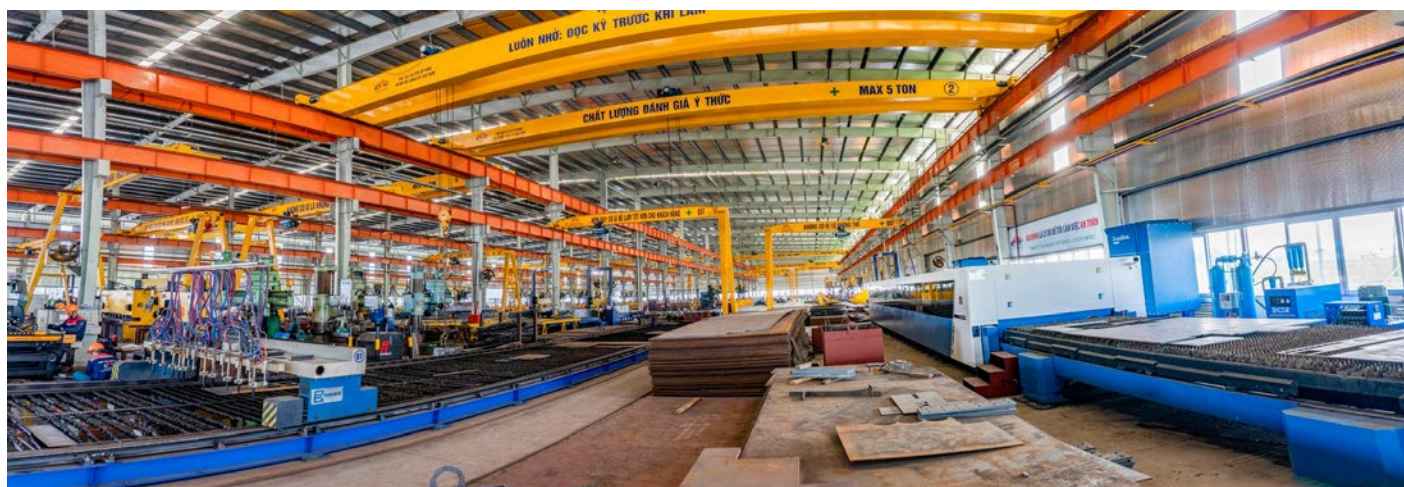

Laser cut machine



Cutting machine

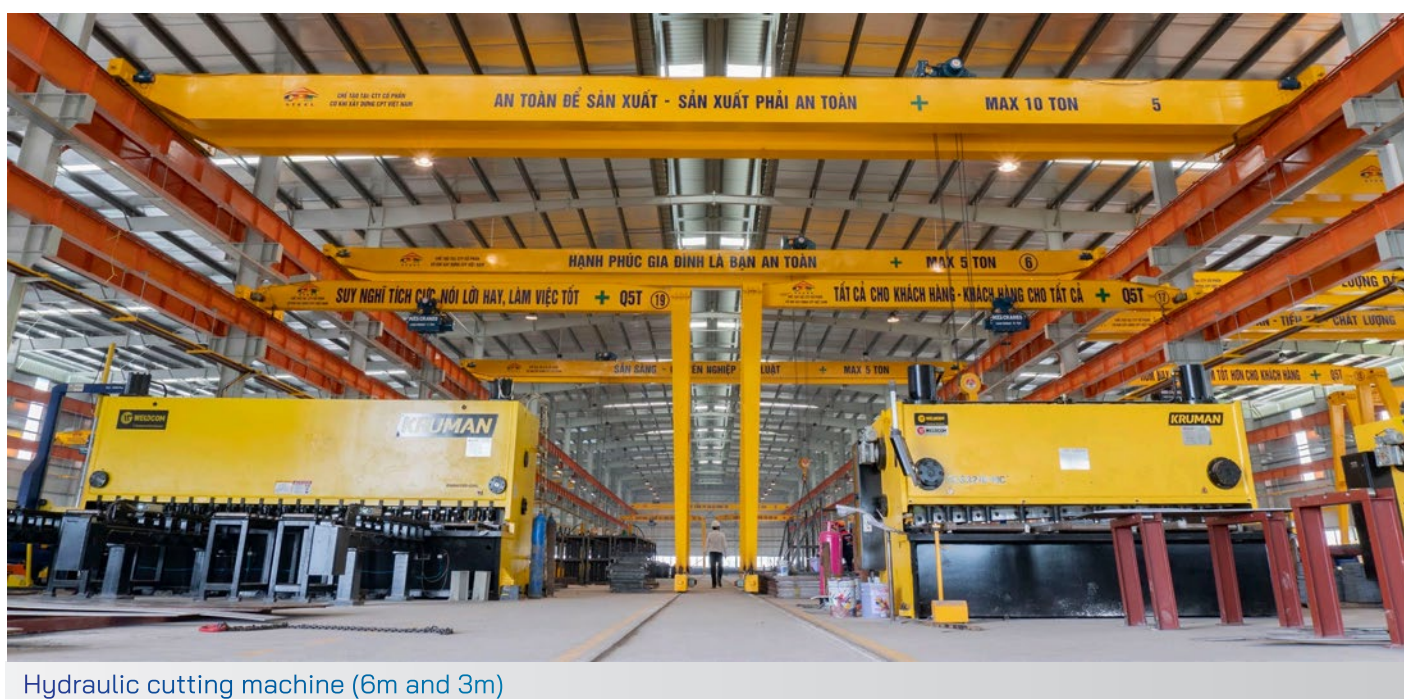

Hydraulic cutting machine (6m and 3m)



Automatic welding machine



Straightening machine

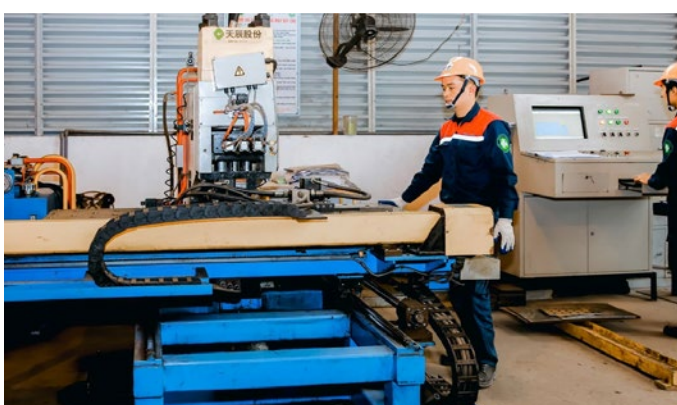

CNC hydraulic punching machine



Hydraulic cutting machine (2m)

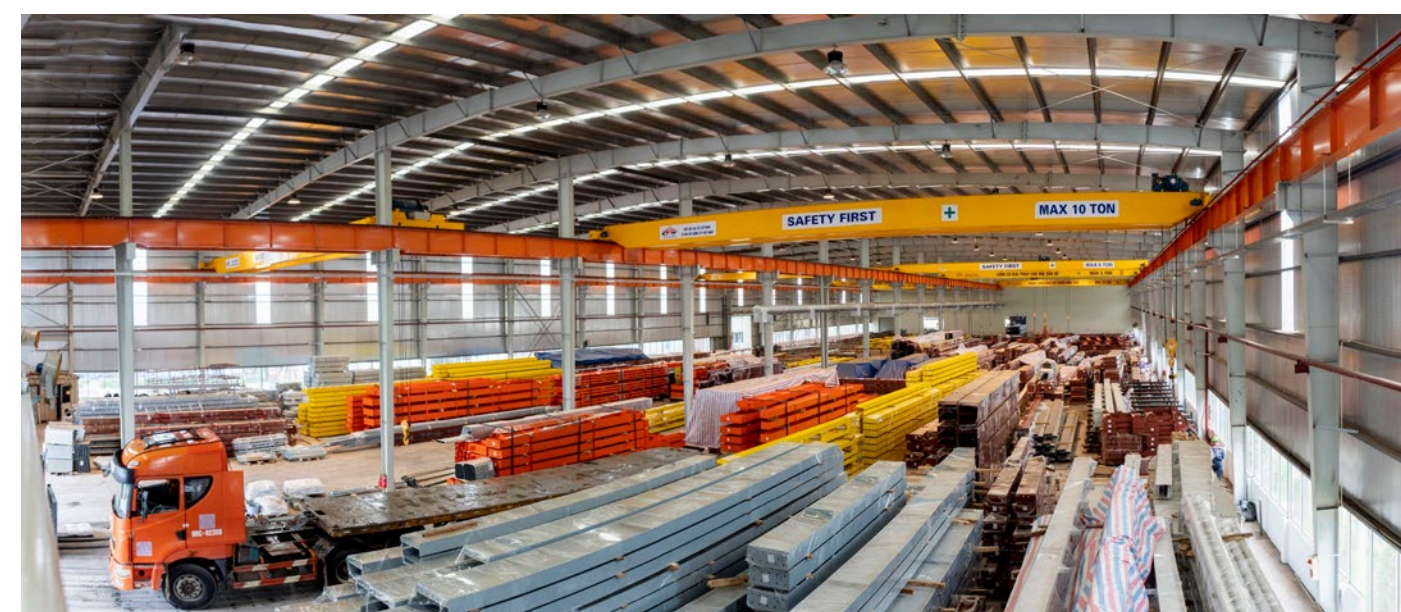

Painting work shop





Over the past 15 years of operation with a team of highly qualified and experienced professionals, modern production equipment, and advanced software development system, our quality commitment has been proven with pre-engineered steel buildings constructed by CPT STEEL. Each project has been tailored to meet the specific needs of our customers, which affirms our commitment to excellent quality. Our Core Values, including Integrity, Honesty, and Quality, have confirmed that CPT STEEL will always bring “satisfaction in cooperation”







Date: October 20th, 2017

## RECOMMENDATION LETTER

To Whom It May Concern,

We, CJSC - Design and Build Contractor with 15 years of experience in the field of industrial construction, confirm that CPT Steel is the professional contractor for steel structure. We cooperated with CPT Steel on our 5 projects:

- Kyungil Optics New Factory located at Binh Xuyen Industrial Zone, Vinh Phuc Province.
- Bando Viet Nam New Factory located at Thang Long 2 Industrial Zone, Hung Yen Province
- Sangshin Electronics New Factory at Dai An Industrial Zone, Hai Duong Province.
- Fuji New Factory at Tan Truong Industrial Zone, Hai Duong Province.
- Kos Hanoi Factory location at Dong Van 2 Industrial Zone, Ha Nam Province.

During implementation of above projects, we have always been satisfied with the quality of projects. CPT STEEL has actively assisted, which contributes to optimize design for works related to steel structure.

CPT STEEL has ensured to complete projects with Safety, Quality.

We would like recommend CPT STEEL to companies looking for an experienced contractor in Design - Production - Installation of steel structure work for factory.

CONSTRUCTION APPLICATION AND  
TRANSFER OF TECHNOLOGIES, JSC  
The Main Contractor  
Chairman

Nguyen Huu Tinh



GIZA E&C, JSC  
Head Office: M Floor - Building A - 071 Hoang Hoa Thiem, Ba Dinh, Hanoi  
Tel: (84-24) 3247 4683  
HCM Office: B1-04 Hoang Anh Gia Lai, Thao Dien, District 2, HCMC  
Tel: (84-28) 2229 9933  
Hotline: 1900 636 168 - Website: Giza.com.vn - Email: contact@giza.com.vn

Date: May 10<sup>th</sup>, 2018

## RECOMMENDATION LETTER

To Whom It May Concern,

We, Giza E&C JSC hereby confirm that CPT STEEL is a professional structure steel contractor with good capacity so we have been confidence in selecting CPT STEEL to perform "Items: steel structure & roofing" of the project Ning An Factory located at Phuoc Son Industrial Zone, Ninh Binh City.

During the project implementation, CPT STEEL has proved that they are an effective, cooperative and professional steel structure Contractor. We are very satisfied with quality and services provided by CPT Steel in product management. CPT STEEL has been successful with Safety, Quality and on Schedule for projects.

We recommend CPT STEEL to any company looking for an effective as well as experienced consultant in Design - Fabrication - Erection of pre-engineered steel building and steel structure work for workshop.

Giza E & C  
Chairman

Ngo Huu Tiep



## Certificate of Registration

The Management System of:

## CPT GROUP JOINT STOCK COMPANY

Room 705, 7th floor, Kim Anh building, no. 1, alley 78, Duy Tan street, Dich Vong Hau ward, Cau Giay district, Hanoi City, Vietnam  
Refer to Attachment to Certificate of Registration dated 14 September 2023 for additional certified sites.

Operates a

## Quality Management System

Which complies with the requirements of

## ISO 9001:2015

For the following scope of certification

**Design and construction of industrial workshop; manufacture and construction of steel structures and pre-engineered steel frame**  
Originally certified against ISO 9001 on 22 June 2020

EA Code: 17, 28, &amp; 34

Certificate of Registration No: VN-10021-QMS

Initial Certification Date: 14 September 2023

Current Certification Date: 14 September 2023

Certificate Issue Date: 26 September 2023

Certificate Expiry Date: 21 June 2026

SIGNATURE

Yevgeniya Mikheyeva  
Operations Manager

Registered by:  
Sustainable Management Group SMG, 78 George Street, Ottawa Ontario, K2N1W1 Canada  
This certificate is subject to the SMG Terms and Conditions for Certification, and remains the property of SMG and must be returned to SMG upon its request.  
To verify that this certificate is current, please refer to SMG online certification register at: <https://smg-sw.com/inquire-about-your-certificate/>

## CERTIFICATE



## Vietnam Certification Association

Hereby certifies that the company:

## CPT GROUP JOINT STOCK COMPANY

Add:  
Hiep Hoa Industrial Cluster, Thang Town, Hiep Hoa District,  
Bac Giang Province, Vietnam

Implemented and maintains an Environmental Management System

Scope:

- Design and construction of industrial factories;
- Production and installation of steel structures and pre-engineered steel buildings.

Through an audit, documented in a report, it was verified that the management system fulfills the requirements of the following standard:

## ISO 14001:2015



Certificate registration no:

VCA 1092.2A

Date of certification:

10 - 07 - 2023

Valid until:

09 - 07 - 2026

Dang Anh Tuan  
General DirectorVITRANCO BUILDING, 182 Tran Thi Trinh,  
Dong Da District, Ha Noi, Vietnam

Address: Floor 5A, Building 159 Nguyen Ngoc Vu Str., Cau Giay Dist., Hanoi  
Website: [www.hicon.vn](http://www.hicon.vn)

Tel: 043 7621 663  
Fax: 043 7621 664Date: April 10<sup>th</sup>, 2018

## THANK LETTER

To CPT Viet Nam mechanical constructions JSC,

Hicon would like to convey our thanks for your successfully completing Contract about: "Fabrication and Erection Steel structure & roofing items" of the project: "Highsum Optoelectronic" in Que Vo Industrial Park2- Bac Ninh province. During the cooperation, CPT Steel has seriously implemented and followed commitment between us. Besides, CPT STEEL has been successful with Safety, Quality and on Schedule for projects with competitive price.

We appreciate the professionalism given by CPT Steel in supporting design consultants, and your high awareness and responsibility during construction process.

Investor and Hicon are very satisfied with quality and services provided by CPT Steel which are proven over time. We hope CPT Steel will maintain and promote the professional working and cooperation.

Wish CPT Steel all the best!

Sincerely,

HICON JSC

TỔNG GIÁM ĐỐC  
Nguyễn Bình ToànDABACO VIETNAM GROUP  
JOINT STOCK COMPANYSocialist Republic of Vietnam  
Independence - Freedom - Happiness

Bac Ninh, May 15th, 2018

## LETTER OF ASSESSMENT

During the course of construction and development of DABACO Vietnam Group, we have been constantly expanding our investment in projects of production factories and trade centers across the country.

Together with the development of the Group, we have always received in construction from professional contractors, including CPT STEEL (CPT STEEL).

We have assigned CPT STEEL to perform major projects of the group such as:

- \* TOPFEEDS high-quality feedstuffs processing plants complex
- \* NUTRENCO feedstuffs processing plants complex
- \* Hiep Quang Packaging Factory Complex
- \* NASACO Ha Nam feedstuffs processing plants complex
- \* DABACO Tan Chi Vegetable Oil Factory Complex
- \* DABACO Gia Binh Trade Center
- \* DABACO Tu Son Trade Center

Based on CPT STEEL's performance of major projects, we assess that:

- CPT STEEL is a contractor who always meets and maintains the criteria of "SAFETY, QUALITY, SCHEDULE, and GOOD SOLUTION".
- CPT STEEL is a professional and reliable contractor.
- DABACO Vietnam always appreciates CPT STEEL.

DABACO Vietnam wishes CPT Vietnam a more sustainable development and always being a good partner to cooperate with us to perform future projects.

Best regards!

FOR AND ON BEHALF OF DABACO VIETNAM GROUP  
JOINT STOCK COMPANY

CHAIRMAN OF THE BOARD  
Nguyễn Nhu So

## CERTIFICATION

Awarded to

## CPT GROUP JOINT STOCK COMPANY

Hiep Hoa Industrial Cluster, Thang Town, Hiep Hoa District, Bac Giang Province, Vietnam

EFC International Certification certifies that the Occupational Health & Safety Management System  
of the above organization has been audited and found to be in accordance with  
the requirements of the management system standards detailed below.

Standard

## ISO 45001:2018

Scope of certification

- Design and construction of industrial factories
- Production and erection of steel structures and pre-engineered steel frames

Original approval date: 10 July, 2023

Subject to the continued satisfactory operation of the organization's Management System,  
this certificate expires on: 10 July, 2026  
To check this certificate validity please call (+84.28) 38 95 96 95 or scan the QR  
Code on this certificate.

Certificate No.: 6202350457

Revision date: 10 July, 2023

EFC International Certification Body



Nguyễn Thị Tra Mi



EFC International Certification  
10th Floor, Pico Sky Building, 14 Nguyen Du Street, Hanoi, V.  
Ha Noi District, Vietnam  
Branch: 24 Van Bac Street, Ba Dinh District, Ha Noi City, Vietnam  
Tel: 024 38 95 96 95  
Email: info@efc-vietnam.com  
www.efc-vietnam.com

## CPT operates according to the ISO standard system:

- Quality Management System: ISO 9001:2015
- Environmental Management System: ISO 14001:2015
- Occupational Health & Safety Management System: ISO 45001:2018





#### JINKO SOLAR (VIETNAM) INDUSTRIES CO.,LTD

Owner: JINKO SOLAR (VIETNAM) INDUSTRIES CO.,LTD  
 Location: Amata IZ, Quang Ninh Province.  
 Project scale:

- PEB: 10.000 tons
- Roof panel and cladding: 100.000 m<sup>2</sup>
- Decking: 60.000 m<sup>2</sup>





# ELECTRONICS PROJECTS



**FUKANG TECHNOLOGY FACTORY**

Owner: Foxconn Singapore PTE Ltd.  
Location: Quang Chau IZ, Bac Giang Province.



**GOERTEK PRECISION  
INDUSTRY VINA FACTORY**

Owner: GOERTEK PRECISION INDUSTRY VIETNAM CO., LT-  
Location: DWHA IZ 1, Nghe An Province.



**WIN BILLION VIET NAM  
FACTORY**

Owner: WIN BILLION VIETNAM TECHNOLOGY COMPANY LIMITED  
Location: Song Cong II IZ, Thai Nguyen Province.





**LUXSHARE - ICT(NGHE AN)  
FACTORY**

Owner: LUXSHARE - ICT (NGHE AN ) LIMITEDV-  
Location: SIP IZ, Nghe An Province.  
Project scale: 50.000 m2



**FOXCONN M11**

Owner: FUHONG PRECISION COMPONENT  
(BAC GIANG) COMPANY LIMITED  
Location: Quang Chau IZ, Bac Giang Province.  
Project scale: 23.782 m2 - 1.000 tons PEB



**LUXSHARE-ICT (VIET NAM) FACTORY**

Owner: LUXSHARE - ICT ( VIETNAM ) LIMITED  
Location: Quang Chau IZ, Bac Giang Province.  
Project scale: 50.000 m2



**FOXCONN F16**

Owner: FUHONG PRECISION COMPONENT  
(BAC GIANG) COMPANY LIMITED  
Location: Quang Chau IZ, Bac Giang Province.  
Project scale: 24.806 m2



# MANUFACTURING, ASSEMBLY AUTOMOBILE PROJECTS



**THANH CONG VIET HUNG AUTOMOBILE & AUXILIARY INDUSTRIAL COMPLEX FACTORY**

Owner: THANH CONG VIET HUNG TECHNOLOGY INDUSTRIAL COMPLEX SJC.  
Location: Viet Hung IZ, Quang Ninh Province.  
Project scale: 4.500 tons.



**BYD (VIET NAM) FACTORY**

Owner: BYD ELECTRONICS (VIETNAM) COMPANY LIMITED  
Location: Phu Ha IZ, Phu Tho Province.  
Project scale: 210.383 m2



**VIET NHAT MOTORS FACTORY**

Owner: VIET NHAT MOTORS JOINT STOCK COMPANY  
Location: Van Giang District, Hung Yen Province.  
Project scale: 67.000 m2



# PACKAGING, GARMENT PROJECTS



**MYS PACKAGING FACTORY**

Owner: MYS Group (Viet Nam) Packaging Technology Co.,Ltd  
 Location: Dong Van IV IZ, Ha Nam Province.  
 Project scale: 650 tons



**HAIVINA HONG LINH FACTORY**

Owner: Haivina Hong Linh Co.,Ltd  
 Location: Nam Hong IZ, Ha Tinh province.  
 Project scale: 25.000 m2



**DRAGON TEXTILES 2 FACTORY**

Owner: Thang Long Investment Exportimport JSC  
 Location: Quynh Phu District, Thai Binh province.  
 Project scale: 9.500 m2 - 521 tons



**DENIM TEXTILE FACTORY**

Owner: TCE VINA DENIM JSC  
 Location: Hoa Xa IZ, Nam Dinh Province  
 Project scale: 9.106 m2



# PRECISION PROJECTS



**VPIC1 FACTORY**

Owner: VIET NAM PRECISION INDUSTRIAL NO.1 CO.,LTD  
Location: Ba Thien 2 IZ, Vinh Phuc Province.  
Project scale: 155.266 m2



**LINH GIANG FACTORY**

Owner: LINH GIANG PRECISION ACCESSORIES INDUSTRY COMPANY LIMITED KCN  
Location: Dong Van I IZ, Ha Nam Province.



**SOLTECT 1 FACTORY**

Owner: SOLTEC VIETNAM COMPANY  
Location: Dong Van II IZ, Ha Nam Province.  
Project scale: 6.000 m2



**HUY HOANG LOCK FACTORY**

Owner: HUY HOANG LOCKS COMPANY LIMITED  
Location: Quang Minh IZ, Ha Noi City.  
Project scale: 10.000 m2



# WARE HOUSE, LOGISTICS PROJECTS



**BWID HAI PHONG**

Owner: BW Industrial Development Hai Phong one member limited Company  
Location: Nam Dinh Vu IZ, Hai Phong Province.  
Project scale: 60.000 m2



**BWID HAI DUONG**

Owner: BW Industrial Development Hai Duong one member limited Company  
Location: VSIP IZ, Hai Duong Province.  
Project scale: 40.000 m2



**SEMCORP NGHE AN**

Owner: Sembcorp Industries (Singapore) Group.  
Location: VSIP Nghe An IZ, Nghe An Province.  
Project scale: 30.000 m2



**SEMCORP QUANG NGAI**

Owner: Sembcorp Industries (Singapore) Group.  
Location: SVIP Quang Ngai IZ, Quang Ngai Province.  
Project scale: 35.500 m2



# SHOPPING MALL PROJECTS



**LIVING WORLD  
KOTA WISATA**

Owner: PT Sahabat Kota Wisata  
Location: Cibubur - Jakarta  
Project scale: 19.716 m2



**LONG BIEN SUPERMARKET**

Owner: Coma 25 Contruction and Tradding JSC  
Location: Quận Long Biên, Hà Nội  
Project scale: 500 tons PEB + 6.000 m2 Decking



**GO THAI BINH  
SHOPPING MALL**

Owner: Central Retail Group.  
Location: Thai Binh City, Thai Binh Province.  
Project scale: 21.000 m2



**DABACO DEN DO  
SHOPPING MALL**

Owner: Dabaco Viet Nam Group.  
Location: Tu Son District, Bac Ninh Province.  
Project scale: 20.000 m2



# FOODSTUFF, ANIMAL FOOD PROJECTS



**DOVECO SON LA FOODSTUFF  
EXPORT FACTORY**

Owner: Dong Giao Foodstuff Export JSC  
Location: Mai Son District, Son La Province.  
Project scale: 500 tons



**DABACO TAN CHI  
FACTORY**

Owner: Dabaco Viet Nam Group.  
Location: Tien Du District, Bac Ninh Province.  
Project scale:



**HAI LONG BINH DINH  
ANIMAL FEED FACTORY**

Owner: HaiD Group  
Location: Hoa Hoi IZ, Binh Dinh Province.  
Project scale: 60.000 m2



## OTHER PROJECTS



## VIETNAM NATIONAL INNOVATION CENTER

Owner: Vietnam National Innovation Center  
 Location: Hoa Lac IZ, Ha Noi City.  
 Project scale: 34.000 m<sup>2</sup>



## TH TRUE MILK THANH HOA

Owner: YENMY MILK FOOD CO.,LTD  
 Location: Nong Cong District, Thanh Hoa Province.  
 Project scale: 1.300.000 m<sup>2</sup>





**SHINKO PIPE PROJECT**

Owner: Shinko Pipe corporation Viet Nam  
Location: Dong van III IZ- Ha Nam Province.

**IYAMA SEIKI VIET NAM  
FACTORY**

Owner: Iiyama Seiki Viet Nam Co.,Ltd  
Location: Nam Cau Kien IZ, Hai Phong Province.

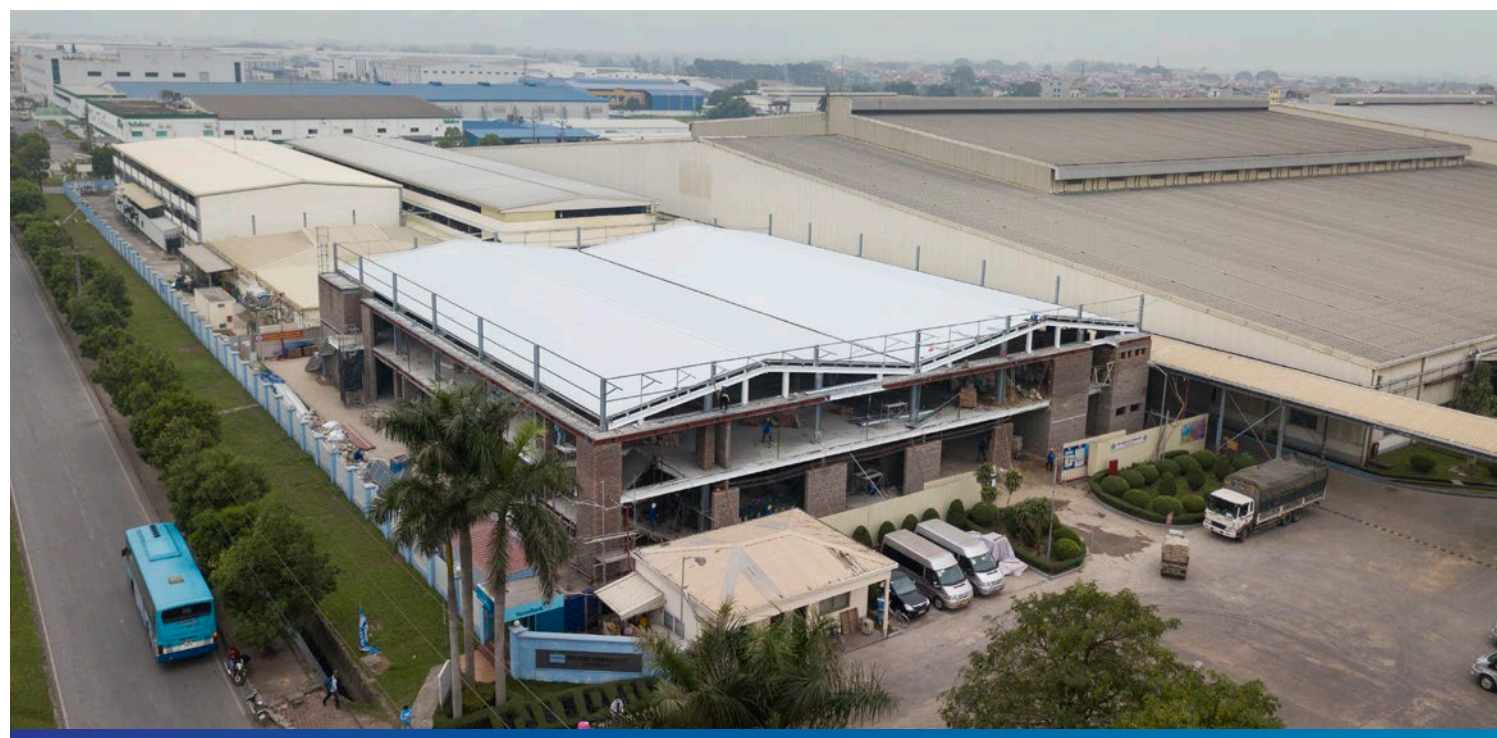
**NITORI FURNITURE VIET NAM  
FACTORY**

Owner: Nitori Furniture Viet Nam Jsc  
Location: Quang Minh IZ, Ha Noi City.

**NAGOYA VIET NAM  
FACTORY**

Owner: Nagoya Viet Nam Industry Company  
Location: Nam Cam IZ, Nghe An Province.





KINGPOST

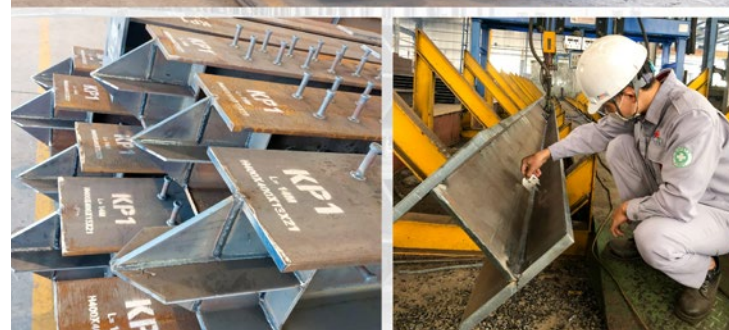

EXPORT PRODUCTS





*Joint development*  
*Joint success*







## CPT GROUP JOINT STOCK COMPANY

 [cptsteel.com](http://cptsteel.com)

**Ha Noi Office:** No 1/78 Duy Tan Street, Hanoi City, VietNam  
**Ho Chi Minh Office:** No 56 Yen The, HoChiMinh City, VietNam

**Factory 1:** Hiep Hoa  
Industrial Cluster,  
BacGiang Province

**Factory 2:** Thang town,  
Hiep Hoa District,  
BacGiang Province

**Factory 3:** Thanhvan  
Industrial Cluster,  
BacGiang Province