

CPT GROUP JOINT STOCK COMPANY



CPT STEEL

PRE-ENGINEERED STEEL BUILDINGS



Joint Development - Joint Success

CONTENTS

01 Open letter
Introduction
Vision, mission, and core values
History
Key Differences

02 CPT STEEL products
Human Resources
Company profile
Production equipment
Labor safety

03 Customers and partners
Letter of assessment
Certificate of Quality
Implemented projects

Open letter

Dear Partners and Customers

CPT GROUP JSC would like to send to partners and customers the most respectful greetings

Along with the development and integration of the Vietnam's economy and larger region's, the industrial construction is also developing. Capital flows of domestic and foreign investors (FDI) are being continuously invested in Vietnam and the region

CPT STEEL, with 19 years of establishment and development, is a professional contractor in the field of steel structures and covering roofing sheets from the stages of "DESIGN, CONSULTATION, FABRICATION, and INSTALLATION. We have dedicated, responsible, dynamic, professional, and high-quality staff, who are always ready to devote for work and for green and sustainable development, and four plants with 18,000 tons/month, which are applied with the quality management system ISO 9001: 2015, ISO 14001:2015, ISO 45001:2015. When carrying out projects, the criteria of SAFETY, QUALITY, SCHEDULE, OPTIMAL SOLUTION, AND COMPETITIVE PRICE are strictly maintained and observed.

The guiding principle in cooperation with partners and customers is being always APPRECIATED BY partners and customers. With years of experience in completing projects that have been highly appreciated and trusted by prestigious domestic and foreign partners and customers, a number of partners have signed strategic cooperation agreements with CPT STEEL.

CPT STEEL is looking forward to working with our partners and customers on suitable projects in order to bring the highest value to the parties and contribute to the green and sustainable development of the economy of Vietnam and the region. We our partners and customers growth and success!

Best regards,



Nguyen Manh Ha
Chairman of the Board



CPT GROUP JOINT STOCK COMPANY

We are one of the leading companies in the field of designing, manufacturing, and supplying pre-engineered steel buildings in Vietnam

With our method of supplying lump-sum services of Design, Fabrication, and Installation of steel structures in general, and pre-engineered steel buildings in particular, we have focused on resources from quality personnel to modern and closed production lines to confidently provide customers with the best solutions for projects to optimize investment costs and quality. Currently, CPT STEEL is able to meet all the demands of designing, manufacturing, and installing steel structures for workshops, warehouses, restaurants, and pre-engineered buildings.

The brand name CPT STEEL has been associated with hundreds of large and small projects in both size and value across the country, which have been recognized and appreciated by customers for the quality and services provided. CPT STEEL is currently a close and long-term partner of domestic and foreign customers.

Focusing on quality to meet the strictest requirements of customers, CPT STEEL has applied the quality management system ISO 9001: 2015, ISO 14001:2015, ISO 45001:2015. so as to satisfy all the toughest investors from places/ countries such as Japan, Korea, Taiwan, Malaysia, Singapore, Hong Kong, The Czech Republic, and Vietnam,...

“Competitive price, good service quality, and guaranteed schedule” is our motto.

Company information

Vietnamese company's name:	CÔNG TY CỔ PHẦN CPT GROUP
Business type:	JOINT STOCK COMPANY
Transaction name in English:	CPT GROUP JOINT STOCK COMPANY
Abbreviated name:	CPT GROUP
Ha Noi Head office:	16th Floor, Heritage West Lake Building, 677 Lac Long Quan Street, Tay Ho Ward, Hanoi City
Factory No.1:	Hiep Hoa Industrial Cluster, Hiep Hoa District, Bac Ninh Province
Factory No.2:	Thang Town, Hiep Hoa District, Bac Ninh Province
Factory No.3:	Thanh Van Industrial Cluster, Hiep Hoa District, Bac Ninh Province
Factory No.4:	Mechanical Product Manufacturing Complex, Chung Village, Hiep Hoa Commune, Bac Ninh Province
Website:	www.cptsteel.com



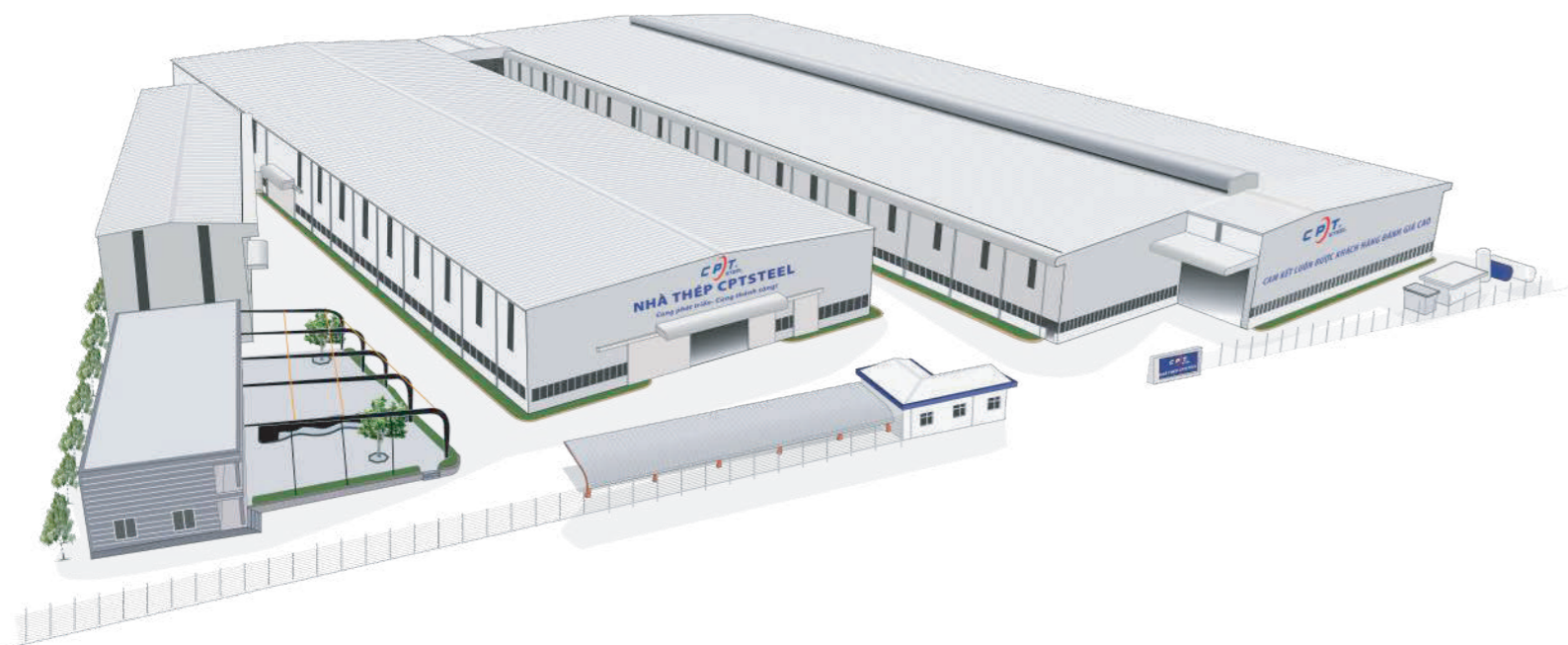

Vision

By 2030, CPT STEEL aims to become the leading brand in Vietnam for manufacturing steel structures and pre-engineered steel buildings. We will also solidify our position as a top reliable export partner in the international market.

Mission

We provide high-quality steel structure and pre-engineered steel building solutions with optimized investment costs and guaranteed progress, thereby contributing to reducing emissions and protecting the environment throughout the project lifecycle.

We put customers at the center, aiming to become the leading trusted choice for quality and service. Concurrently, we build a safe, friendly, and development-rich working environment for every employee, contributing to enhancing community welfare.

We strictly adhere to professional business ethics, delivering sustainable value to shareholders, partners, and society.

Core values

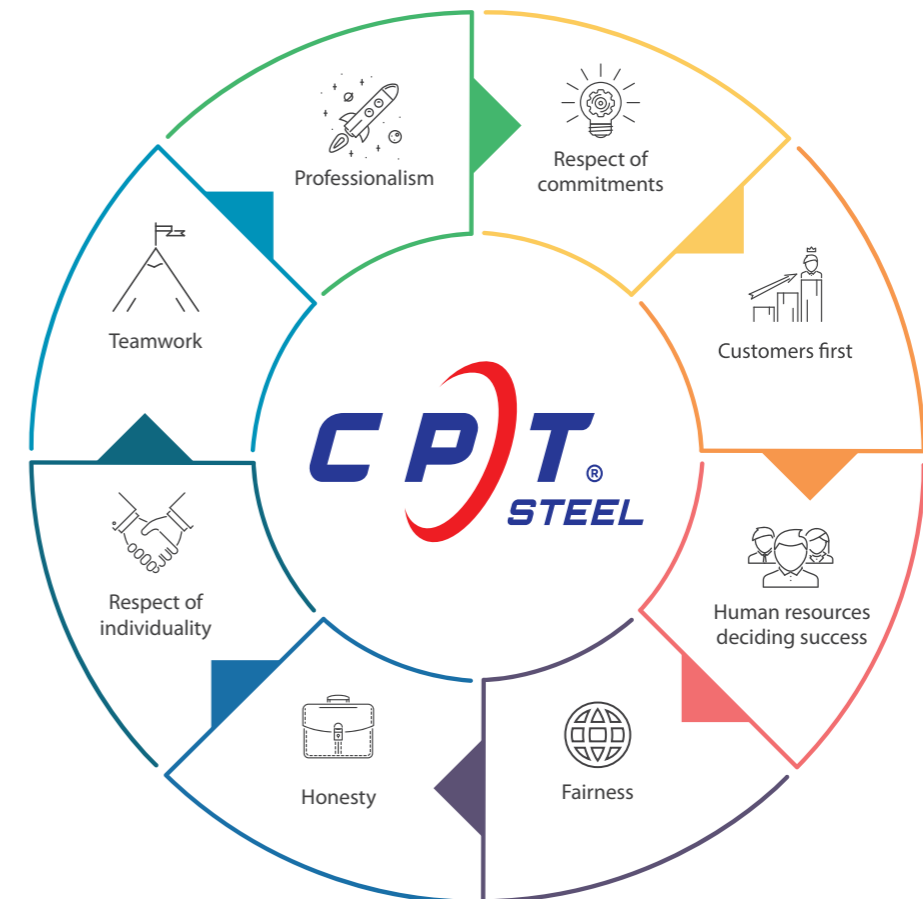

Professionalism

The team of highly qualified staff have a professional and dedicated manners & behavior to ensure the success of the CPT STEEL brand.

Respect of commitments

CPT STEEL has always seriously implemented its commitments, including internal commitments and commitments to customers

Customers first

Customer satisfaction is the goal for all our activities

Respect of individuality

Employees have always been given the maximum opportunities to promote their capacity, develop themselves, and succeed with the company. They have always been listened to and advised by their colleagues regardless of their positions. They dare to speak straight and share their thoughts and views in the spirit of mutual respect, fairness and equality in every situation

Fairness

CPT STEEL has always treated employees, customers, suppliers, and stakeholders fairly.

Honesty

CPT STEEL has always emphasized honesty in relationships and transactions with customers and suppliers

Human Capital as the Core Pillar

Human resources are the central development element affecting success or failure. Therefore, CPT STEEL has always focused on investing in training and development of human resources.

Teamwork

There are common beliefs and goals for the development of the company Collaborative & Inclusive Culture. People help, support, show concern, and treat each other like brothers

HISTORY

2007

Establishment of CPT Vietnam Mechanical Construction JSC; Completion and commencement of the steel structure factory with a capacity of 300 tons/month.

2010

Expansion of the working office and investment in upgrading the production line of the factory, raising the capacity to 500 tons/month.

2012

Official opening of the company's representative office in Hanoi

2015

Adoption of the investment policy to build the factory to meet the increasing demand of the market; construction of factory No.2 was officially commenced on an area of 3.5 hectares in November

2016

Completion and commencement of the steel structure factory No. 02 with a comprehensively modern and highly automatic production line.
Workshop area: 20,000 m²
Capacity: 1,300 tons/month
Total investment: VND 80 billion



2021

Official opening of the company's representative office in Ho Chi Minh City and Over Sea office in Philippines and Indonesia, in crease export ratio.

2022

Completion and commencement of the steel structure factory No. 03. total capitor CPTSTEEL a 8.000 tons/ month.
Conversion of CPT Vietnam Mechanical Construction JSC to CPT Group JSC.

2024

Opened a representative office in Japan

2025

Commencement of the mechanical product manufacturing complex construction in Bac Ninh.
Opened a representative office in Indonesia.

...

Our projects have been implemented in several countries

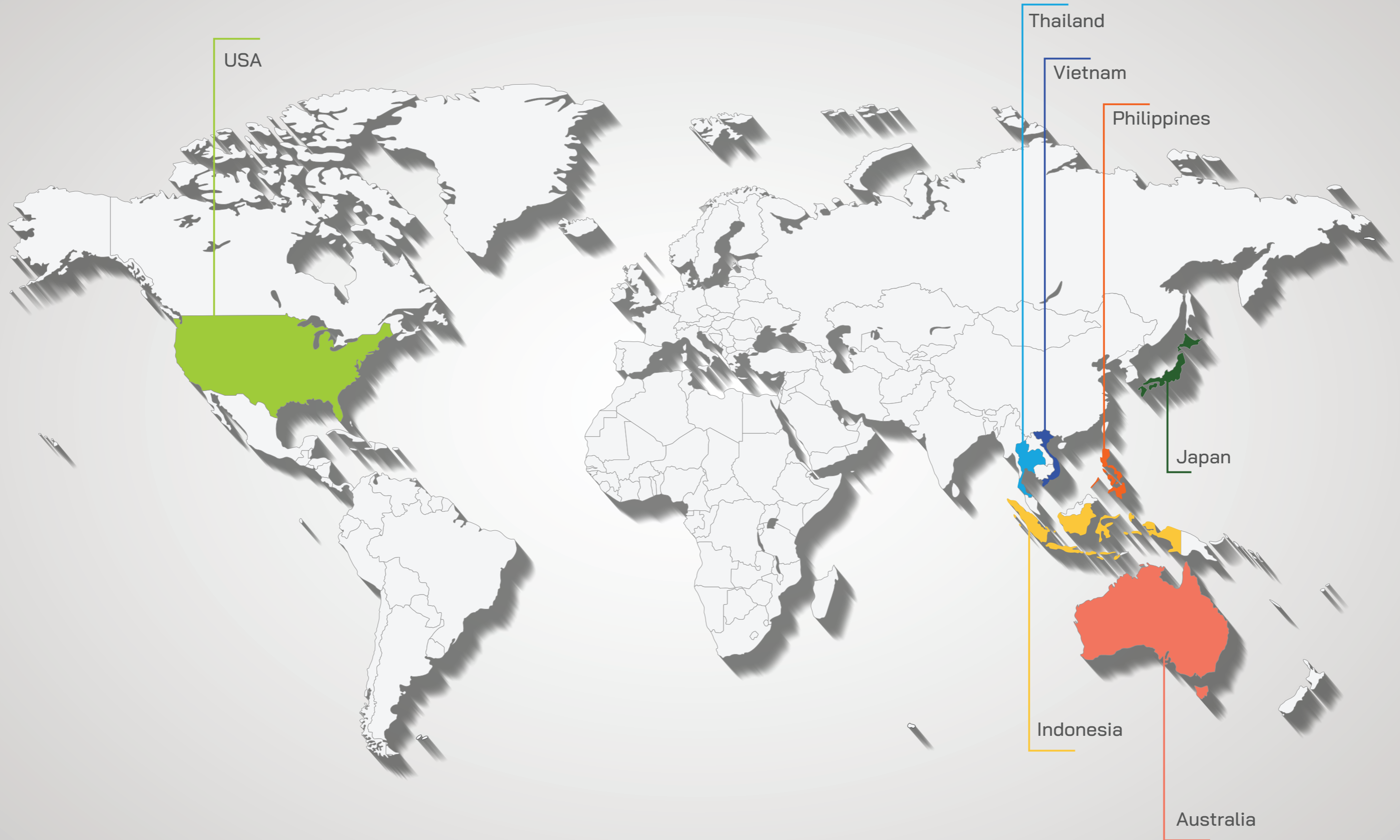





We recognize that investing in self-development and human development can bring about sustainable values in the long run. With a solid orientation and accumulated and constantly improved production line system and production technology, we have equipped our staff with a solid knowledge base, keen occupational thinking, and a spirit of non-stop practice, application, and self-development right down to the smallest daily task to reach the goal of making the biggest difference from the factory to the site, making the most cost-effective, high-quality products for our customers



DESIGN

All creative and coordination efforts in design and consultation are to provide the best solutions. With a creative, experienced, and dedicated team of designers, CPT STEEL is proud to bring hundreds of customers the optimal designs in the field of pre-engineered steel buildings



MANUFACTURING

With a modern production line and experienced, skilled, and well-trained stars, CPT STEEL will always bring high-quality products to customers



CONSTRUCTION

Labour safety is always a priority of CPT STEEL. The Company engineers and erection workers have been regularly trained in the field of labour safety



WARRANTY SERVICES.

Not only does the warranty service help minimize risks and incidents, but it also enhances the value and trust of the construction project. CPT STEEL is committed to quality and professional services. The warranty service plays a crucial role in building long-term relationships and fostering trust with our customers.

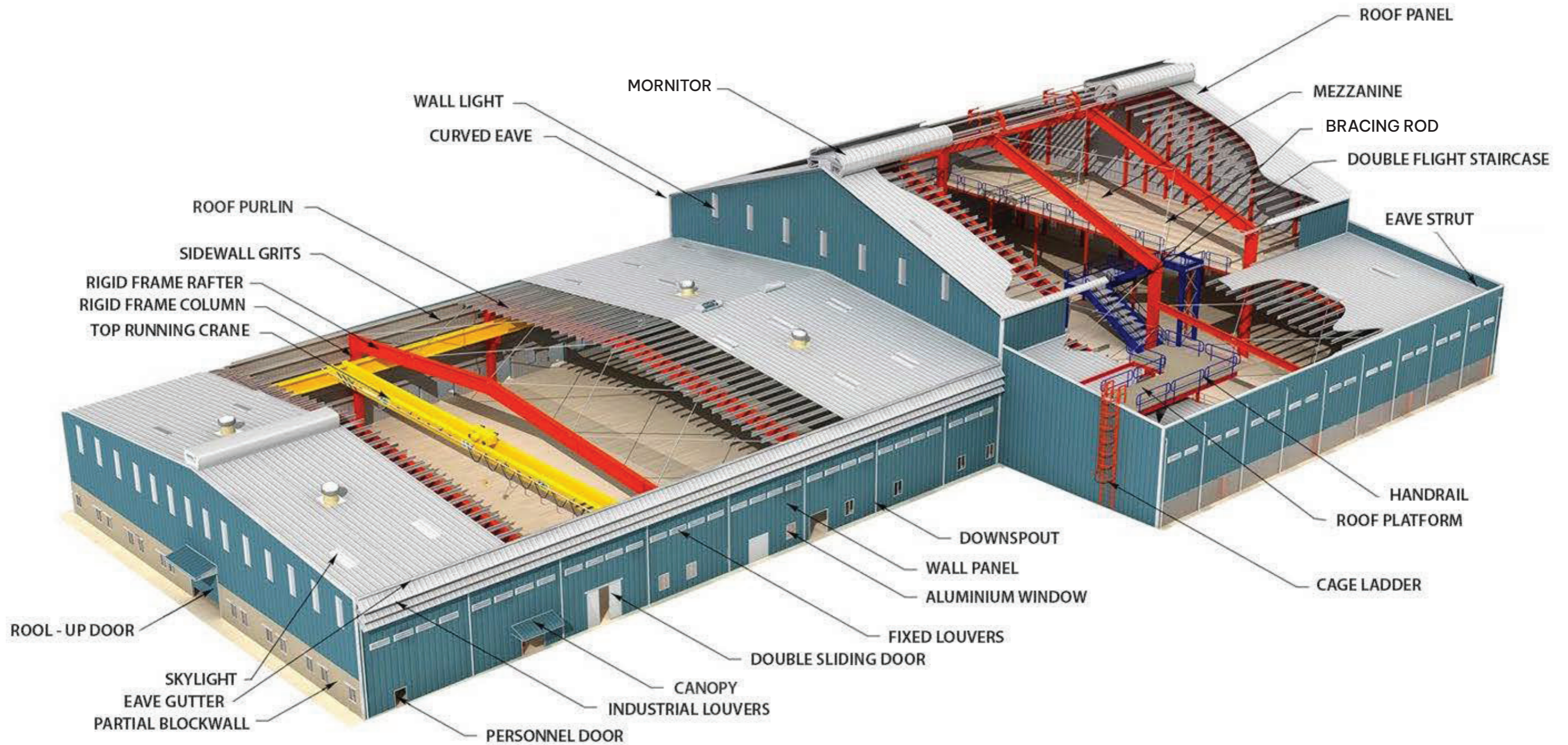

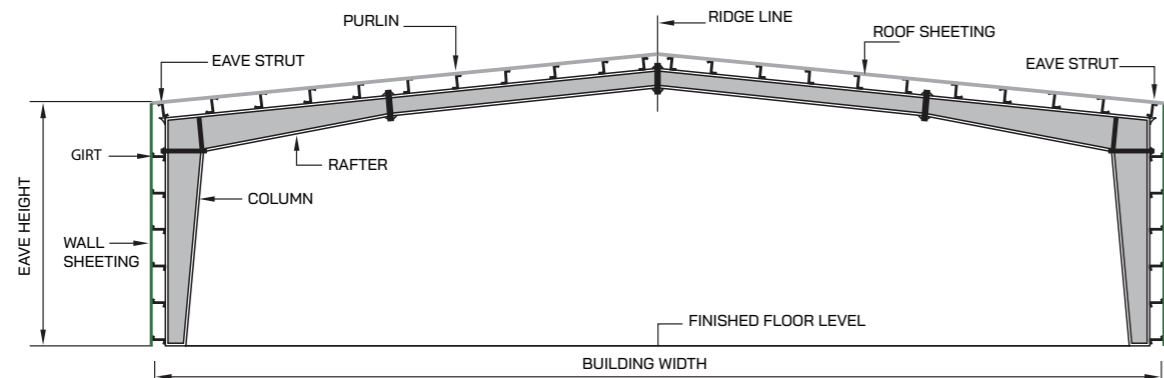

Typical Cross Section

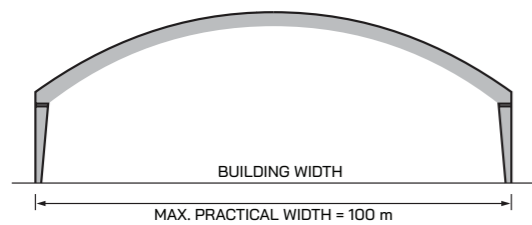

Built-up Curved Rafter (BU)

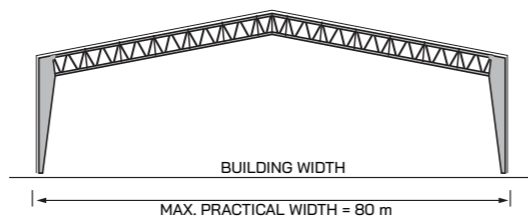

Hybrid

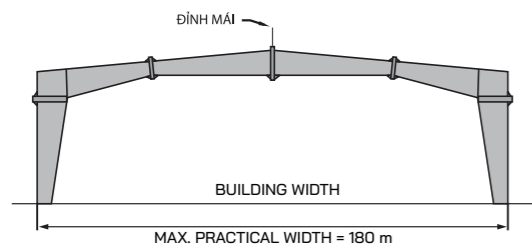

Clear Span (CS)

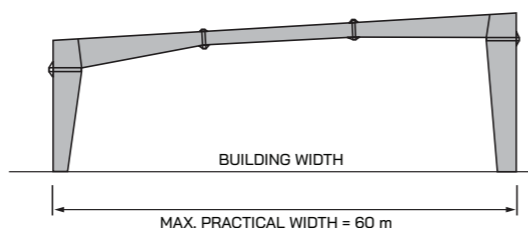

Single Slope (SS)

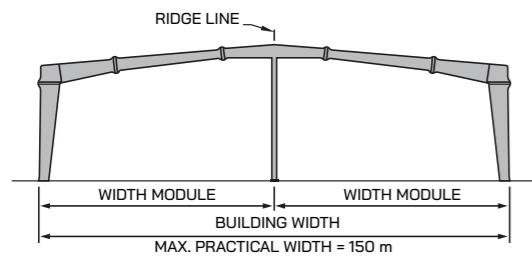

Multi-Span "1" (MS-1)

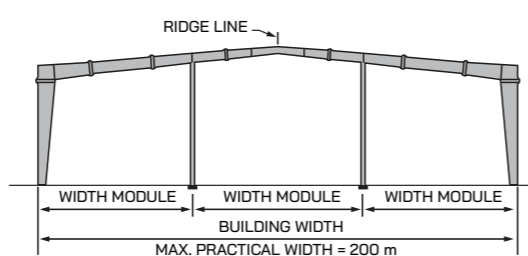

Multi-Span "2" (MS-2)

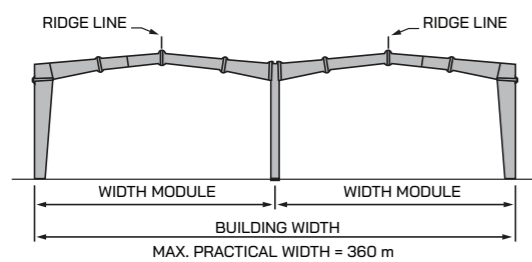

Multi-Gable (MG)

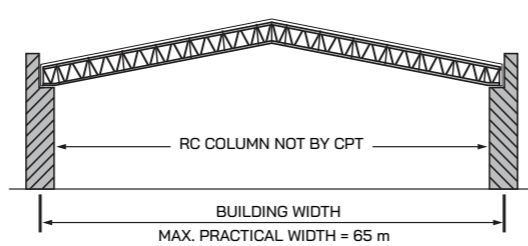

Roof System (RS)

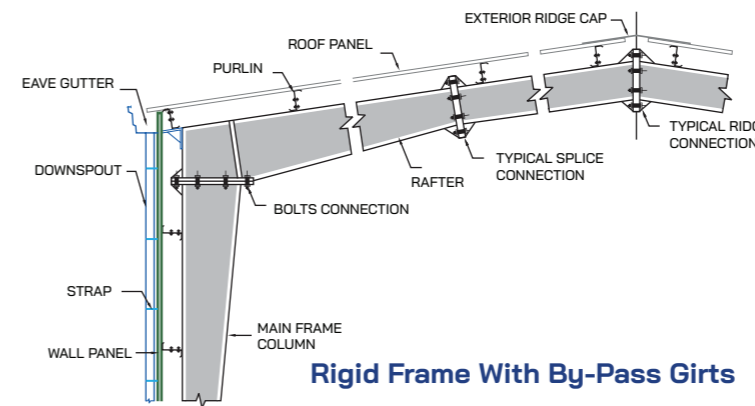

Rigid Frame With By-Pass Girts

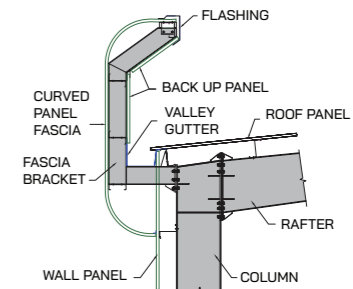

Curved Fascia

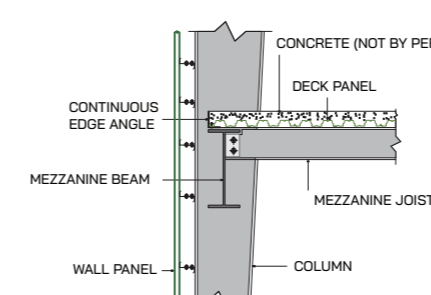

Mezzanine Joist Connection to Mezzanine Beam

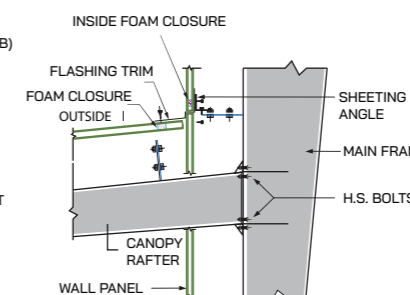

Canopy

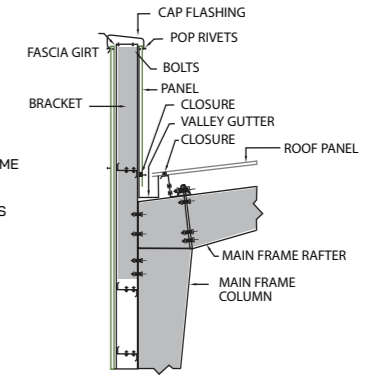

Parapet Fascia

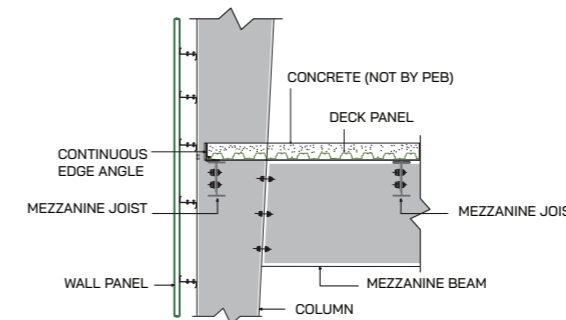

Mezzanine Beam Connection to Main Frame Column

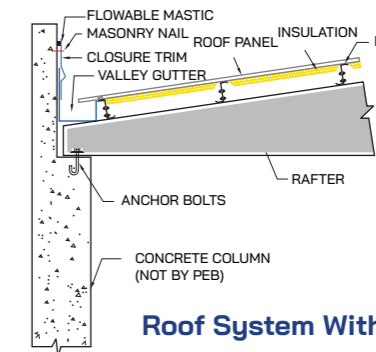

Roof System With Insulation

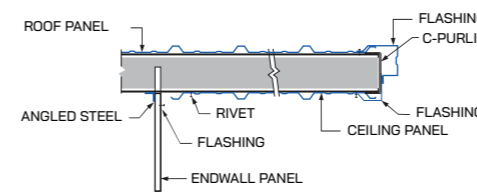

Endwall Roof Extension With Soffit

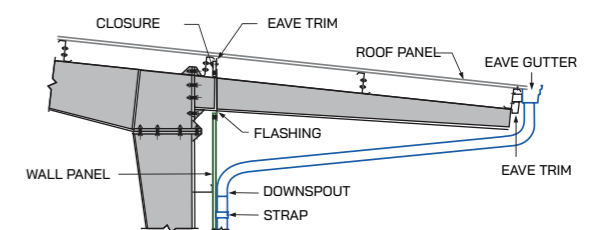

Sidewall Roof Extension

CPT STEEL Pre-Engineered Steel Buildings - The best solution for your project. If a project needs cost savings, quick installation, and absolute and sustainable quality control, CPT STEEL pre-engineered steel buildings are the best choice. Pre-Engineered Steel Buildings are the latest construction trend in the world. Pre-engineered steel buildings are increasingly asserting outstanding advantages in the field of industrial and civil construction such as factories, warehouses, high-rise buildings, showrooms, heavy industry, or infrastructure ...

High-rise structure



Workshop structure



High tower structure



Pipe Rack System



Decking

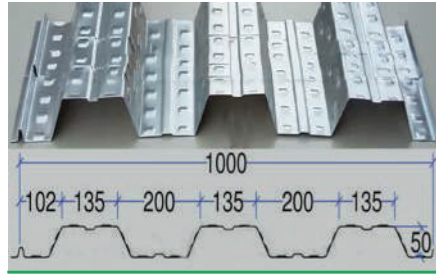

Decking H =50

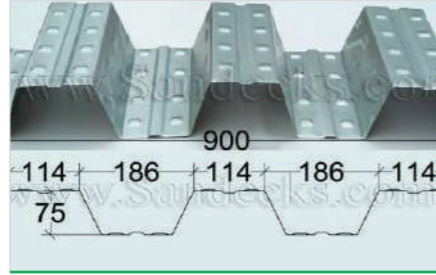

Decking H =75



Speed Decking

Purlin

CPT STEEL supplies purlins from normal strength to high strength with galvanization Z80 - Z275

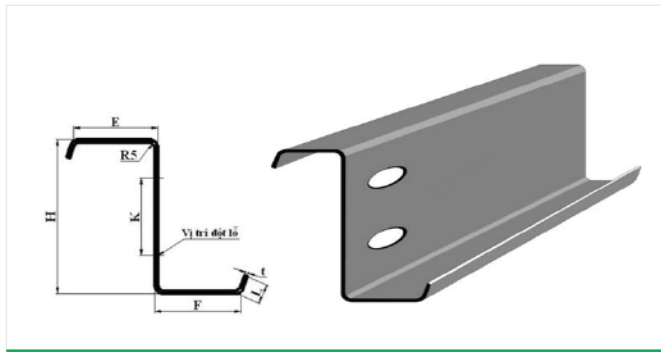

Z Purlin

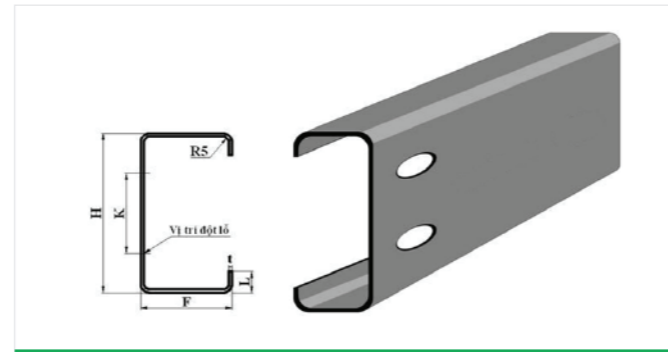

C Purlin

Overhead Crane

CPT STEEL is currently developing and supplying various types of overhead cranes

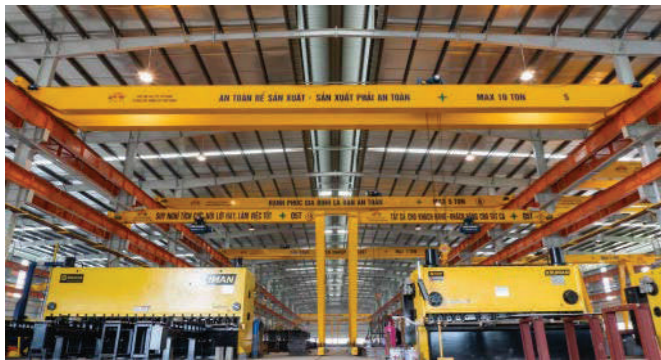

crane modul



crane quality check

THERMAL INSULATION COVERING MATERIALS

Currently, CPT STEEL provides a full range of solutions for covering materials to industrial factories

Steel panel



05 (06) ribs Steel Panel

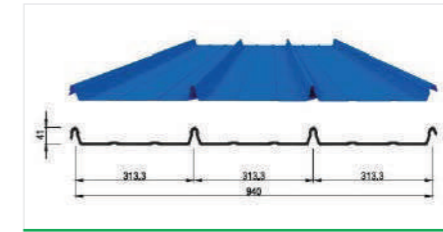

Kliplock Steel Panel

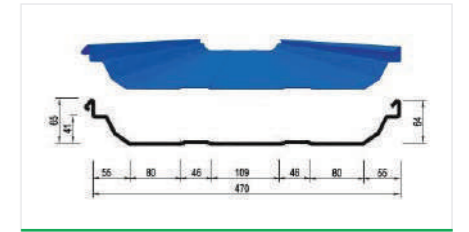

Seamlok Steel Panel

Insulating materials

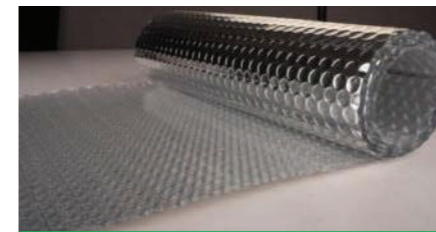

Air-bag insulation



Glass wool insulation



Rockwool

Insulation panel

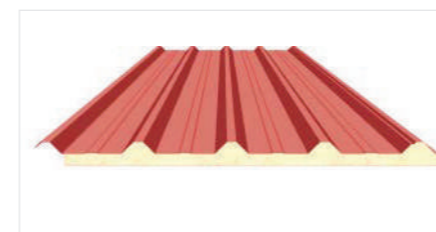

EPS/PU Sandwich panel - 3 layers

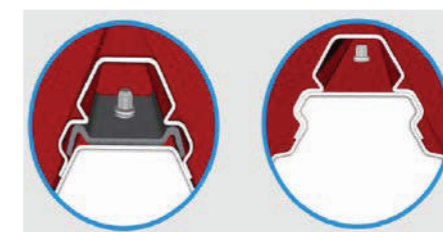

Screw cap for roof panel

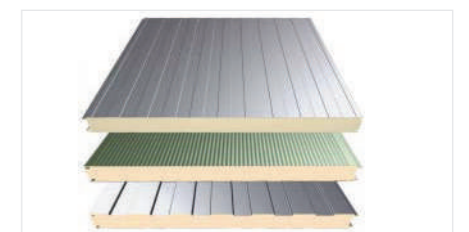

Sandwich panel

Supplier partner





People are the core and decisive element in all CPT STEEL's activities. Therefore, at CPT STEEL, we are determined to build a team of experienced, qualified workers who always have the spirit of the highest responsibility and professionalism

In the process of formation and development, despite many difficulties and challenges, CPT STEEL, as a family, constantly researches techniques and improves skills and production capacity towards the goal of becoming one of the strongest enterprises in the domestic and international markets.

Human resources diagram

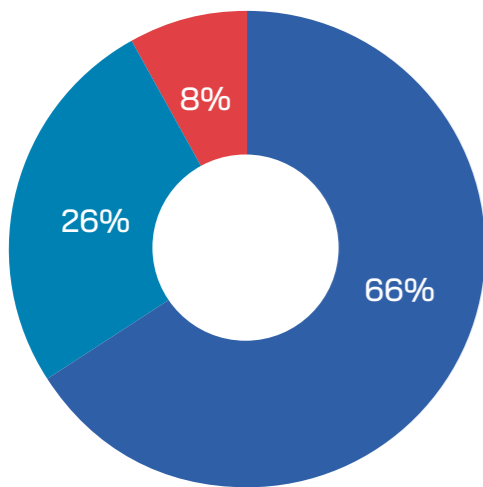

Classification:

- Leaders and Managers: 8 %
- Engineers: 26 %
- Workers : 66 %

Organizational chart

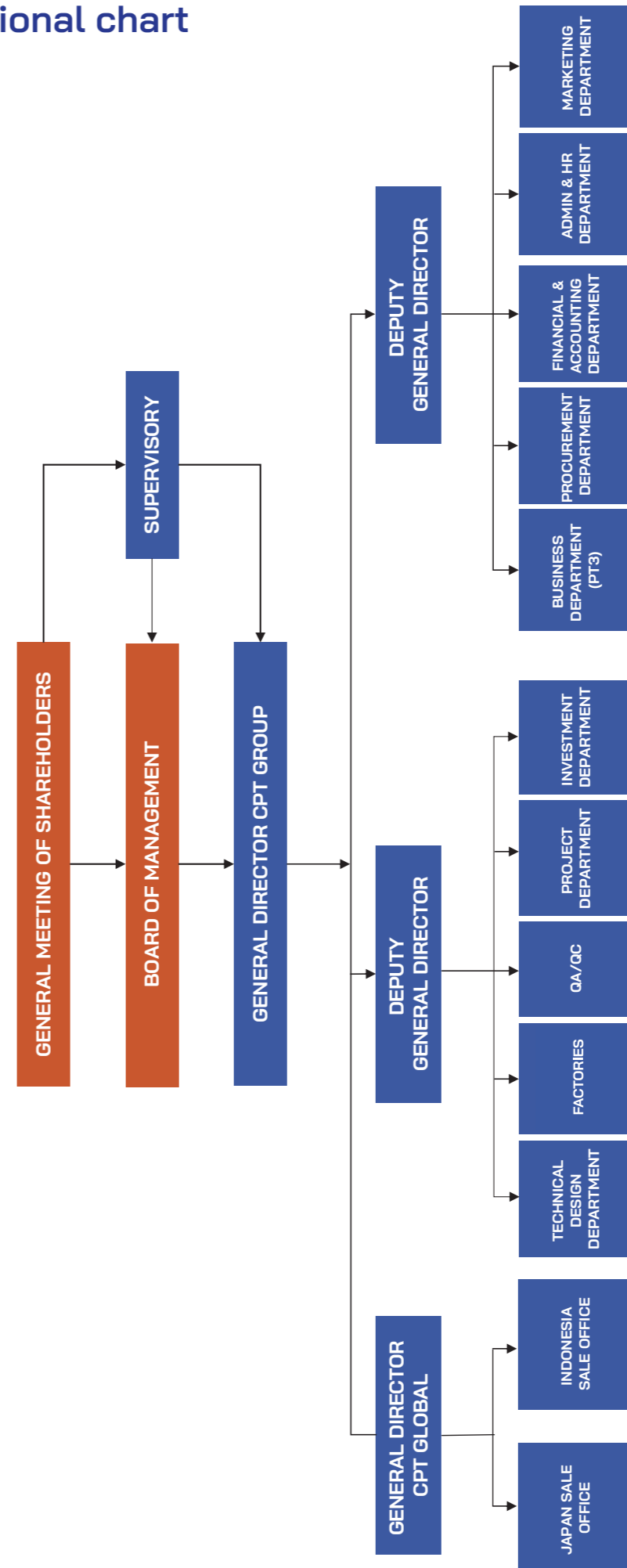

Capacity of CPT STEEL

CPT STEEL HAS FOUR FACTORIES WITH TOTAL AREA OF OVER 17 HA. THE TOTAL PRODUCTIVITY OF THE FACTORIES IS UP TO 18,000 TONS/MONTH. THE FACTORIES HAVE MORE THAN 500 EXPERIENCED, QUALIFIED, AND WELL-TRAINED EMPLOYEES.





FACTORY NO 1

- Construction area: 10.000 m²
- Capacity: 1.200 tons/month.



FACTORY NO 2

- Construction area: 35.000 m²
- Capacity: 2.600 tons/month.



FACTORY NO 3

- Construction area: 30.000 m²
- Capacity: 4.200 tons/month.



FACTORY NO 4

- Construction area: 96.000 m²
- Capacity: 10.000 tons/month.

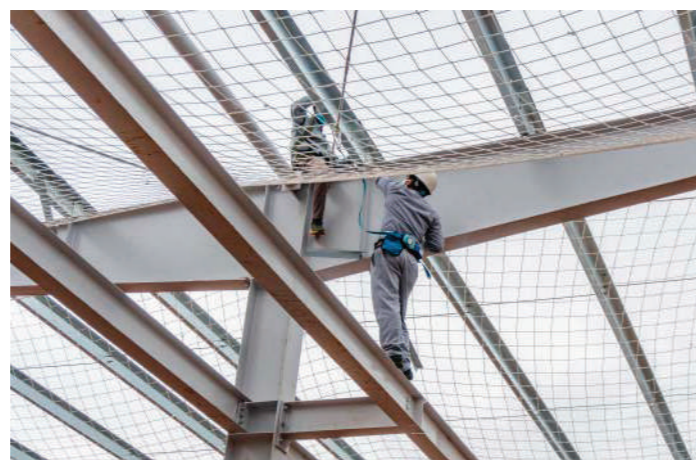

At CPT STEEL, equipment is always modernized. Products manufactured by modern and closed production lines from the processing of raw materials to finished products are processed by an imported machine system with high-precision and high-capacity.



Laser cut machine

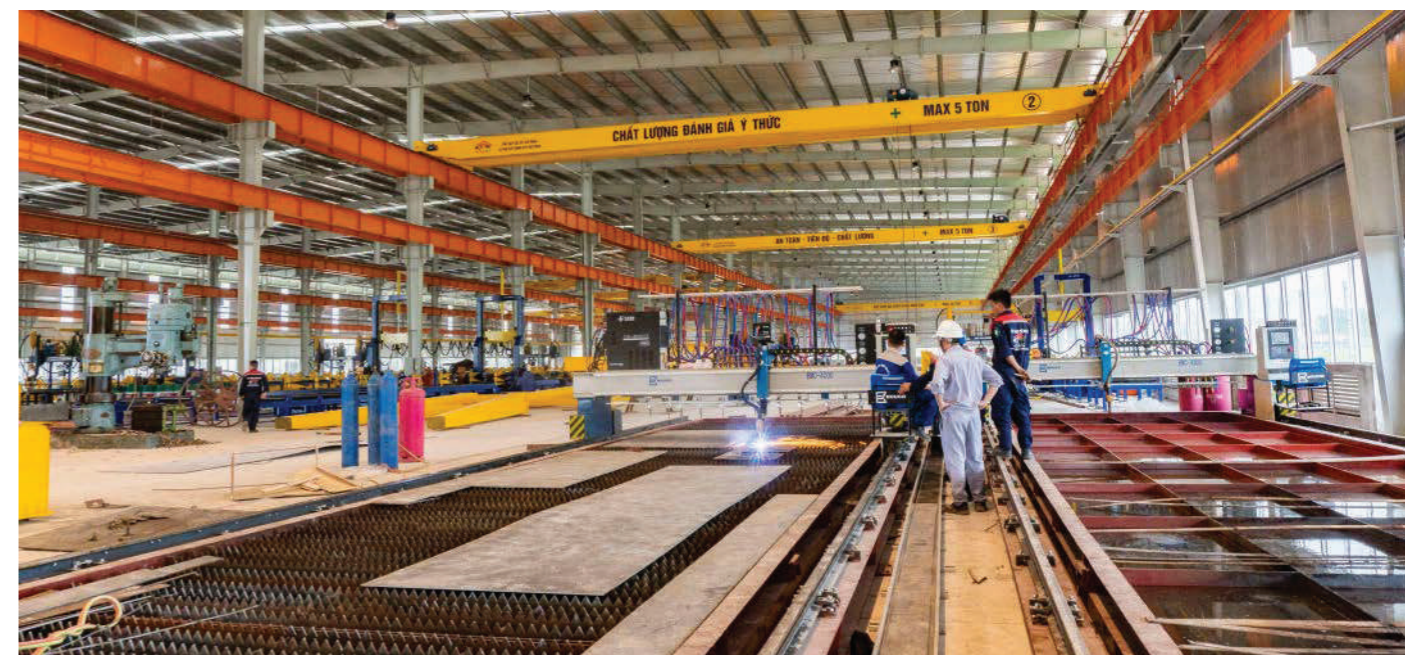

Cutting machine

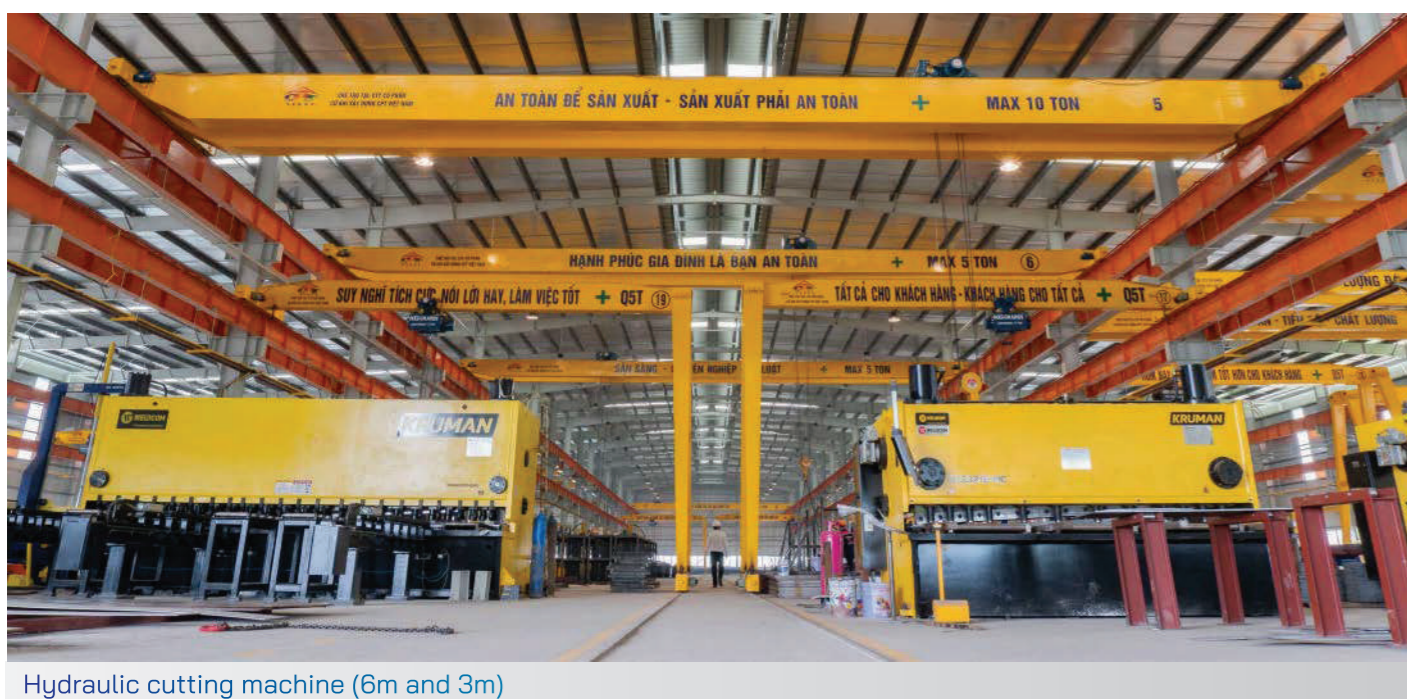

Hydraulic cutting machine (6m and 3m)



Automatic welding machine



Straightening machine

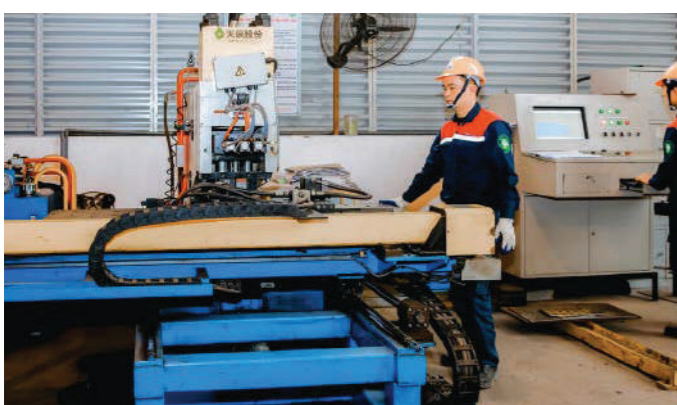

CNC hydraulic punching machine



Hydraulic cutting machine (2m)



Painting workshop



Over the past nearly 20 years of operation with a team of highly qualified and experienced professionals, modern production equipment, and advanced software development system, our quality commitment has been proven with pre-engineered steel buildings co-constructed by CPT STEEL. Each project has been tailored to meet the specific needs of our customers, which affirms our commitment to excellent quality. Our Core Values, including Integrity, Honesty, and Quality, have confirmed that CPT STEEL will always bring "satisfaction in cooperation"

CJSC
Date: October 20th, 2017
RECOMMENDATION LETTER

To Whom It May Concern,

We, CJSC - Design and Build Contractor with 15 years of experience in the field of industrial construction, confirm that CPT Steel is the professional contractor for steel structure. We cooperated with CPT Steel on our 5 projects:

- Kyungil Optics New Factory located at Binh Xuyen Industrial Zone, Vinh Phuc Province.
- Bando Viet Nam New Factory located at Thang Long 2 Industrial Zone, Hung Yen Province
- Sangshin Electronics New Factory at Dai An Industrial Zone, Hai Duong Province.
- Fuji New Factory at Tan Truong Industrial Zone, Hai Duong Province.
- Kos Hanoi Factory location at Dong Van 2 Industrial Zone, Ha Nam Province.

During implementation of above projects, we have always been satisfied with the quality of projects. CPT STEEL has actively assisted, which contributes to optimize design for works related to steel structure.

CPT STEEL has ensured to complete projects with Safety, Quality.

We would like recommend CPT STEEL to companies looking for an experienced contractor in Design - Production - Installation of steel structure work for factory.

CONSTRUCTION APPLICATION AND TRANSFER OF TECHNOLOGIES, JSC
The Main Contractor
Chairman

Nguyen Huu Tinh
Nguyen Huu Tinh

Investor's confidence

GIZA E&C, JSC
Head Office: M Floor - Building A - 671 Hoang Hoa Thám, Ba Đình, Hanoi
Tel: (84-24) 2247 4888
HCM Office: 281-04 Hoàng Anh Gia Lai, Tân Định, District 2, HCMC
Tel: (84-28) 2129 9955
Hotline: 1909 636 168 - Website: Giza.com.vn - Email: contact@giza.com.vn

Date: May 10th, 2018
RECOMMENDATION LETTER

To Whom It May Concern,

We, Giza E&C JSC hereby confirm that CPT STEEL is a professional structure steel contractor with good capacity so we have been confidence in selecting CPT STEEL to perform "Items: steel structure & roofing" of the project Ning An Factory located at Phuc Son Industrial Zone, Ninh Binh City.

During the project implementation, CPT STEEL has proved that they are an effective, cooperative and professional steel structure Contractor. We are very satisfied with quality and services provided by CPT Steel in product management. CPT STEEL has been successful with Safety, Quality and on Schedule for projects.

We recommend CPT STEEL to any company looking for an effective as well as experienced consultant in Design - Fabrication - Erection of pre-engineered steel building and steel structure work for workshop.

Giza E & C
Chairman
Ngô Hữu Tiếp
Ngô Hữu Tiếp

smg
Sustainable Management Group

Certificate of Registration

The Management System of:
CPT GROUP JOINT STOCK COMPANY
Room 705, 7th floor, Kim Anh building, no. 1, alley 78, Duy Tan street, Dich Vong Hau ward, Cau Giay district, Hanoi City, Vietnam
Refer to Attachment to Certificate of Registration dated 14 September 2023 for additional certified sites.

Operates a
Quality Management System
Which complies with the requirements of
ISO 9001:2015
For the following scope of certification
Design and construction of industrial workshop; manufacture and construction of steel structures and pre-engineered steel frame
Originally certified against ISO 9001 on 22 June 2020

EA Code: 17, 28, & 34
Certificate of Registration No: VN-10021-QMS

Initial Certification Date: 14 September 2023
Current Certification Date: 14 September 2023
Certificate Issue Date: 26 September 2023
Certificate Expiry Date: 21 June 2026

SIGNATURE
Yevgeniya Mikheyeva
Yevgeniya Mikheyeva
Operations Manager

SMG ISO 9001 IAS IAF

Registered by:
Sustainable Management Group SMG, 78 George Street, Ottawa Ontario, K1N1W1 Canada
This certificate is subject to the SMG Terms and Conditions for Certification, and remains the property of SMG and must be returned to SMG upon its request.
To verify that this certificate is current, please refer to SMG online certification register at: <https://smg-aw.com/inquire-about-your-certificate/>

CERTIFICATE
VCA

Vietnam Certification Association

Hereby certifies that the company:
CPT GROUP JOINT STOCK COMPANY

Address:
Hiep Hoa Industrial Cluster, Thang Town, Hiep Hoa District, Bac Giang Province, Vietnam

Implemented and maintains an Environmental Management System

Scope:
- Design and construction of industrial factories;
- Production and installation of steel structures and pre-engineered steel buildings.

Through an audit, documented in a report, it was verified that the management system fulfills the requirements of the following standard:
ISO 14001:2015

Certificate registration no: VCA.1062.2A
Date of certification: 10 - 07 - 2023
Valid until: 09 - 07 - 2026

ĐÔNG ANH TUẤN
General Director
VITRAMCO BUILDING, P82 Thuy Thinh, Dong Da District, Ha Noi, Vietnam.

HICON
Address: Floor 5A, Building 159 Nguyen Ngọc Vũ Str., Cau Giay Dist., Hanoi
Website: www.hicon.vn
Tel: 043 7621 693
Fax: 043 7621 664

Date: April 10th, 2018
THANK LETTER

To CPT Viet Nam mechanical constructions JSC.

Hicon would like to convey our thanks for your successfully completing Contract about: "Fabrication and Erection Steel structure & roofing items" of the project: "Hightsun Optoelectronic" in Que Vo Industrial Park2- Bac Ninh province. During the cooperation, CPT Steel has seriously implemented and followed commitment between us. Besides, CPT STEEL has been successful with Safety, Quality and on Schedule for projects with competitive price.

We appreciate the professionalism given by CPT Steel in supporting design consultants, and your high awareness and responsibility during construction process.

Investor and Hicon are very satisfied with quality and services provided by CPT Steel which are proven over time. We hope CPT Steel will maintain and promote the professional working and cooperation.

Wish CPT Steel all the best!

Sincerely,
HICON JSC
Nguyễn Đức Toàn
TỔNG GIÁM ĐỐC
Nguyễn Đức Toàn

DABACO VIETNAM GROUP JOINT STOCK COMPANY
Socialist Republic of Vietnam
Independence - Freedom - Happiness
Bac Ninh, May 15th, 2018

LETTER OF ASSESSMENT

During the course of construction and development of DABACO Vietnam Group, we have been constantly expanding our investment in projects of production factories and trade centers across the country.

Together with the development of the Group, we have always received in construction from professional contractors, including CPT STEEL (CPT STEEL).

We have assigned CPT STEEL to perform major projects of the group such as:

- * TOPFEEDS high-quality feedstuffs processing plants complex
- * NUTRENCO feedstuffs processing plants complex
- * Hiep Quang Packaging Factory Complex
- * NASACO Ha Nam feedstuffs processing plants complex
- * DABACO Tan Chi Vegetable Oil Factory Complex
- * DABACO Gia Binh Trade Center
- * DABACO Tu Son Trade Center

Based on CPT STEEL's performance of major projects, we assess that:

- CPT STEEL is a contractor who always meets and maintains the criteria of "SAFETY, QUALITY, SCHEDULE, and GOOD SOLUTION".
- CPT STEEL is a professional and reliable contractor.
- DABACO Vietnam always appreciates CPT STEEL.

DABACO Vietnam wishes CPT Vietnam a more sustainable development and always being a good partner to cooperate with us to perform future projects.

Best regards!
FOR AND ON BEHALF OF DABACO VIETNAM GROUP JOINT STOCK COMPANY
Nguyễn Như Sơn
CHAIRMAN OF THE BOARD
Nguyễn Như Sơn

EFC
CERTIFICATION

Awarded to
CPT GROUP JOINT STOCK COMPANY
Hiep Hoa Industrial Cluster, Thang Town, Hiep Hoa District, Bac Giang Province, Vietnam

EFC International Certification certifies that the Occupational Health & Safety Management System of the above organization has been audited and found to be in accordance with the requirements of the management system standards detailed below.

Standard
ISO 45001:2018
Scope of certification
• Design and construction of industrial factories
• Production and erection of steel structures and pre-engineered steel frames

Original approval date: 10 July, 2023
Subject to the continued satisfactory operation of the organization's Management System, this certificate expires on: 10 July, 2026
To check this certificate validity please call (+84.28) 38 95 96 95 or scan the QR Code on this certificate.

Certificate No: 6202350457
Revision date: 10 July, 2023

EFC International Certification Body
Nguyễn Thị Trà Mi
Nguyễn Thị Trà Mi

EFC International Certification
10th Floor, Pico Sky Building, 14 Nguyen Quoc Thuan Street, Binh Duong, Ho Chi Minh City, Vietnam
Phone: +84 28 38 95 96 95
Email: info@efc.com.vn

CPT operates according to the ISO standard system:

- Quality Management System: ISO 9001:2015
- Environmental Management System: ISO 14001:2015
- Occupational Health & Safety Management System: ISO 45001:2018

Software certification and Local Code, Vietnam Code, US code,

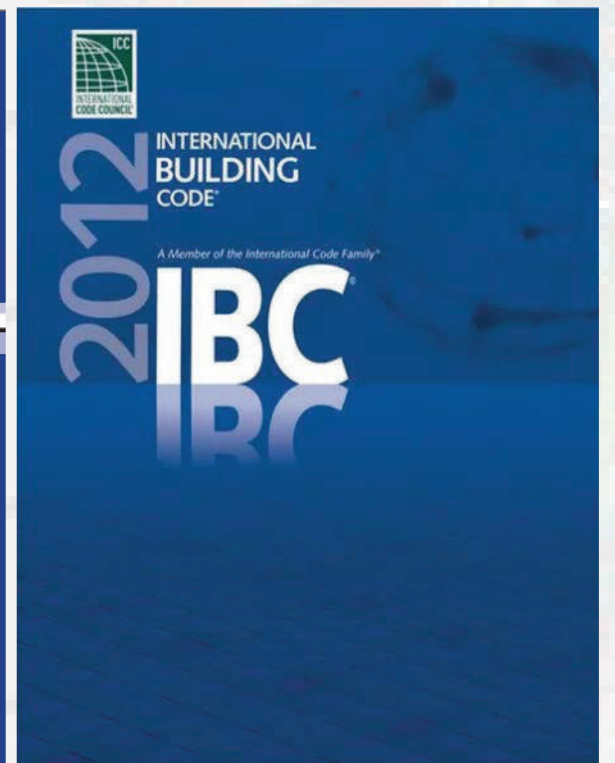
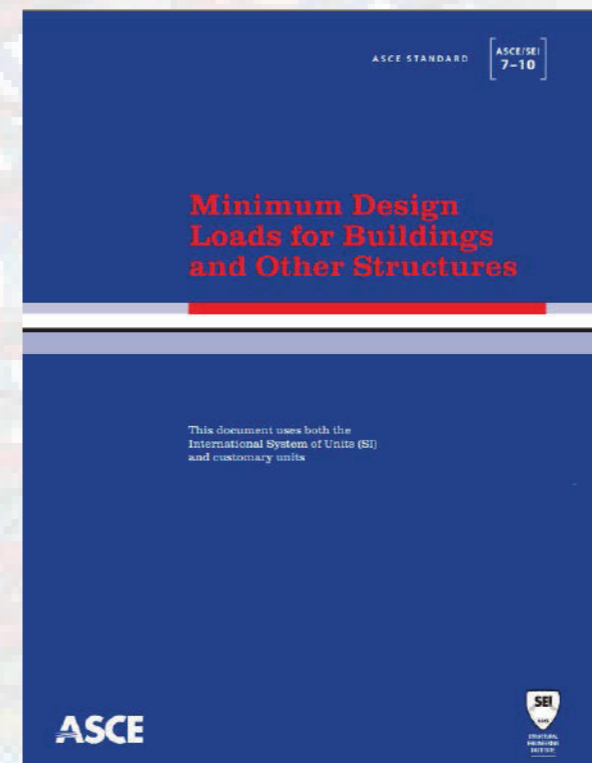
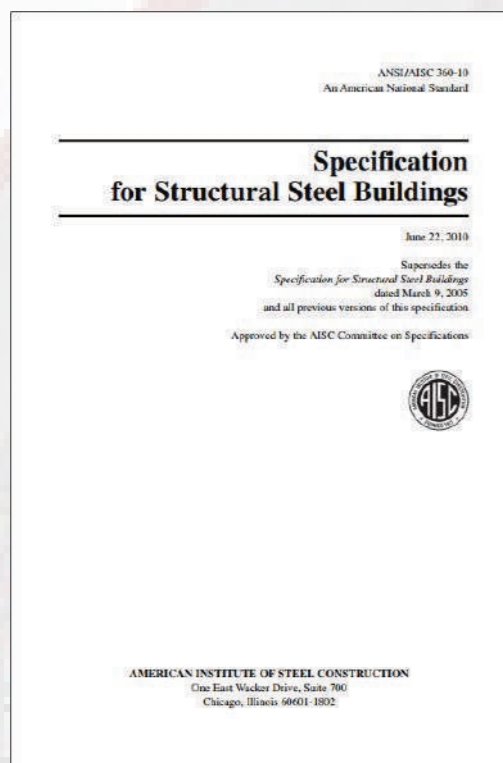
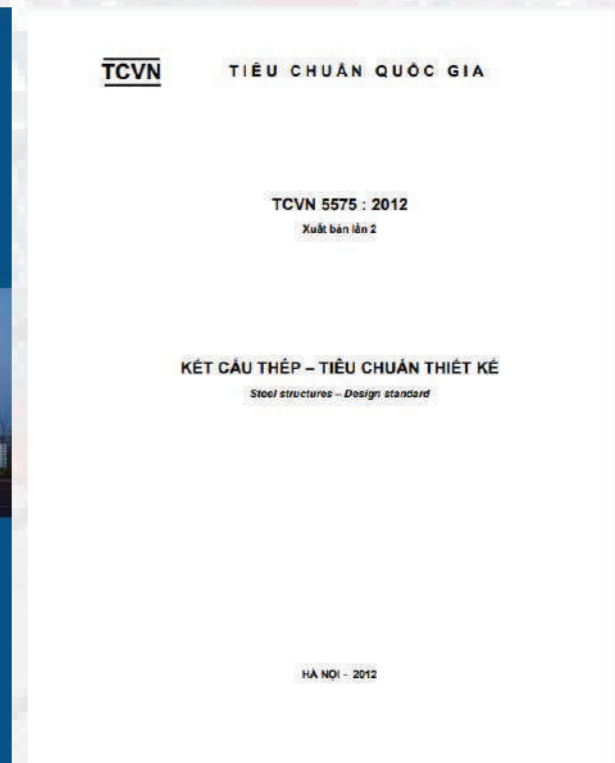
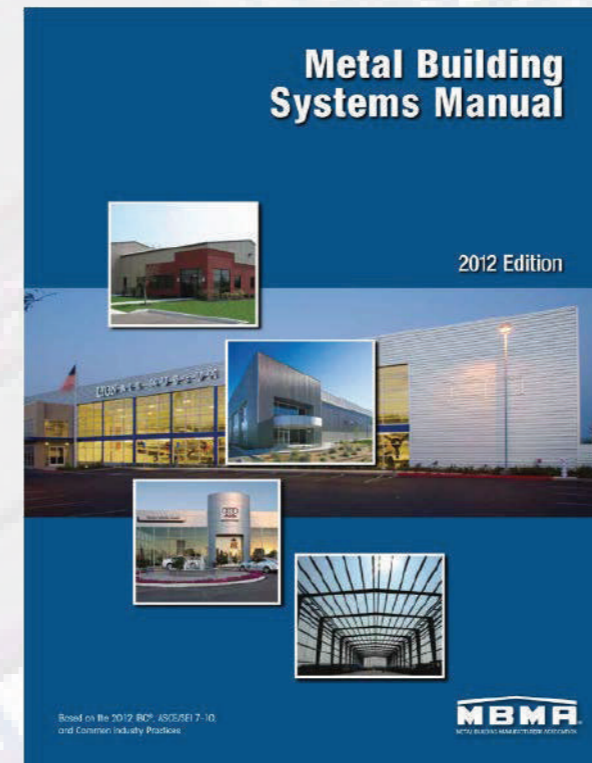



JINKO SOLAR (VIETNAM) INDUSTRIES CO.,LTD

Owner: JINKO SOLAR (VIETNAM) INDUSTRIES CO.,LTD
 Location: Amata IZ, Quang Ninh Province.
 Project scale: - PEB: 10.000 tons
 - Roof panel and cladding: 100.000 m²
 - Decking: 60.000 m²



ELECTRONICS PROJECTS



FUKANG TECHNOLOGY FACTORY

Owner: Foxconn Singapore PTE Ltd.
Location: Quang Chau IZ, Bac Giang Province.



GOERTEK PRECISION INDUSTRY VINA FACTORY

Owner: GOERTEK PRECISION INDUSTRY VIETNAM CO., LT-
Location: DWHA IZ 1, Nghe An Province.



WIN BILLION VIET NAM FACTORY

Owner: WIN BILLION VIETNAM TECHNOLOGY COMPANY LIMITED
Location: Song Cong II IZ, Thai Nguyen Province.



LUXSHARE - ICT(NGHE AN) FACTORY

Owner: LUXSHARE - ICT (NGHE AN) LIMITEDV-
 Location: SIP IZ, Nghe An Province.
 Project scale: 50.000 m2



FOXCONN M11

Owner: FUHONG PRECISION COMPONENT (BAC GIANG) COMPANY LIMITED
 Location: Quang Chau IZ, Bac Giang Province.
 Project scale: 23.782 m2 - 1.000 tons PEB



LUXSHARE-ICT (VIET NAM) FACTORY

Owner: LUXSHARE - ICT (VIETNAM) LIMITED
 Location: Quang Chau IZ, Bac Giang Province.
 Project scale: 50.000 m2



FOXCONN F16

Owner: FUHONG PRECISION COMPONENT (BAC GIANG) COMPANY LIMITED
 Location: Quang Chau IZ, Bac Giang Province.
 Project scale: 24.806 m2

MANUFACTURING, ASSEMBLY AUTOMOBILE PROJECTS



THANH CONG VIET HUNG AUTOMOBILE & AUXILIARY INDUSTRIAL COMPLEX FACTORY

Owner: THANH CONG VIET HUNG TECHNOLOGY INDUSTRIAL COMPLEX SJC.
Location: Viet Hung IZ, Quang Ninh Province.
Project scale: 4.500 tons.



BYD (VIET NAM) FACTORY

Owner: BYD ELECTRONICS (VIETNAM) COMPANY LIMITED
Location: Phu Ha IZ, Phu Tho Province.
Project scale: 210.383 m²



VIET NHAT MOTORS FACTORY

Owner: VIET NHAT MOTORS JOINT STOCK COMPANY
Location: Van Giang District, Hung Yen Province.
Project scale: 67.000 m²

PACKAGING, GARMENT PROJECTS



MYS PACKAGING FACTORY

Owner: MYS Group (Viet Nam) Packaging Technology Co.,Ltd
Location: Dong Van IV IZ, Ha Nam Province.
Project scale: 650 tons



HAIVINA HONG LINH FACTORY

Owner: Haivina Hong Linh Co.,Ltd
Location: Nam Hong IZ, Ha Tinh province.
Project scale: 25.000 m2



DRAGON TEXTILES 2 FACTORY

Owner: Thang Long Investment Exportimport JSC
Location: Quynh Phu District, Thai Binh province.
Project scale: 9.500 m2 - 521 tons



DENIM TEXTILE FACTORY

Owner: TCE VINA DENIM JSC
Location: Hoa Xa IZ, Nam Dinh Province
Project scale: 9.106 m2

PRECISION PROJECTS



VPIC1 FACTORY

Owner: VIET NAM PRECISION INDUSTRIAL NO.1 CO.,LTD
 Location: Ba Thien 2 IZ, Vinh Phuc Province.
 Project scale: 155.266 m2



LINH GIANG FACTORY

Owner: LINH GIANG PRECISION ACCESSORIES INDUSTRY COMPANY LIMITEDKCN
 Location: Dong Van I IZ, Ha Nam Province.



SOLTECT 1 FACTORY

Owner: SOLTEC VIETNAM COMPANY
 Location: Dong Van II IZ, Ha Nam Province.
 Project scale: 6.000 m2



HUY HOANG LOCK FACTORY

Owner: HUY HOANG LOCKS COMPANY LIMITED
 Location: Quang Minh IZ, Ha Noi City.
 Project scale: 10.000 m2

WARE HOUSE, LOGISTICS PROJECTS



BWID HAI PHONG

Owner: BW Industrial Development Hai Phong one member limited Company
Location: Nam Dinh Vu IZ, Hai Phong Province.
Project scale: 60.000 m2



BWID HAI DUONG

Owner: BW Industrial Development Hai Duong one member limited Company
Location: VSIP IZ, Hai Duong Province.
Project scale: 40.000 m2



SEMCORP NGHE AN

Owner: Sembcorp Industries (Singapore) Group.
Location: VSIP Nghe An IZ, Nghe An Province.
Project scale: 30.000 m2



SEMCORP QUANG NGAI

Owner: Sembcorp Industries (Singapore) Group.
Location: SVIP Quang Ngai IZ, Quang Ngai Province.
Project scale: 35.500 m2

SHOPPING MALL PROJECTS



(+84)942 306 888

cptsteel.com

f /ketcauthepCPTSTEEL

#KOTA Project

LIVING WORLD KOTA WISATA

Owner: PT Sahabat Kota Wisata
 Location: Cibubur - Jakarta
 Project scale: 19.716 m2



LONG BIEN SUPERMARKET

Owner: Coma 25 Construction and Trading JSC
 Location: Quận Long Biên, Hà Nội
 Project scale: 500 tons PEB + 6.000 m2 Decking



GO THAI BINH SHOPPING MALL

Owner: Central Retail Group.
 Location: Thai Binh City, Thai Binh Province.
 Project scale: 21.000 m2



DABACO DEN DO SHOPPING MALL

Owner: Dabaco Viet Nam Group.
 Location: Tu Son District, Bac Ninh Province.
 Project scale: 20.000 m2

FOODSTUFF, ANIMAL FOOD PROJECTS



DOVECO SON LA FOODSTUFF EXPORT FACTORY

Owner: Dong Giao Foodstuff Export JSC
Location: Mai Son District, Son La Province.
Project scale: 500 tons



DABACO TAN CHI FACTORY

Owner: Dabaco Viet Nam Group.
Location: Tien Du District, Bac Ninh Province.
Project scale:



HAI LONG BINH DINH ANIMAL FEED FACTORY

Owner: HaiD Group
Location: Hoa Hoi IZ, Binh Dinh Province.
Project scale: 60.000 m2

OTHER PROJECTS



VIETNAM NATIONAL INNOVATION CENTER

Owner: Vietnam National Innovation Center
 Location: Hoa Lac IZ, Ha Noi City.
 Project scale: 34.000 m2



TH TRUE MILK THANH HOA

Owner: YENMY MILK FOOD CO.,LTD
 Location: Nong Cong District, Thanh Hoa Province.
 Project scale: 1.300.000 m2





SHINKO PIPE PROJECT

Owner: Shinko Pipe corporation Viet Nam
Location: Dong van III IZ- Ha Nam Province.



IYAMA SEIKI VIET NAM FACTORY

Owner: Iiyama Seiki Viet Nam Co.,Ltd
Location: Nam Cau Kien IZ, Hai Phong Province.



NITORI FURNITURE VIET NAM FACTORY

Owner: Nitori Furniture Viet Nam Jsc
Location: Quang Minh IZ, Ha Noi City.



NAGOYA VIET NAM FACTORY

Owner: Nagoya Việt Nam Industry Company
Location: Nam Cam IZ, Nghe An Province.



KINGPOST

EXPORT PRODUCTS



CPTSTEEL



KẾT CẤU THÉP CPTSTEEL KẾT CẤU THÉP CPTSTEEL KẾT CẤU THÉP CPTSTEEL KẾT CẤU THÉP CPTSTEEL KẾT CẤU THÉP CPTSTEEL KẾT CẤU THÉP CPTSTEEL

A large-scale construction site showing the steel framework of a building. The structure consists of numerous vertical columns and horizontal beams, with a dense grid of smaller steel members forming the roof structure. Two flags are visible: a red flag with a yellow star on the left and a white flag with a red emblem on the right. The sky is a clear, light blue.

Joint development
Joint success



CPT GROUP JOINT STOCK COMPANY

 cptsteel.com

Ha Noi Office:

16th Floor, Heritage West Lake Building,
677 Lac Long Quan Street, Tay Ho Ward, Hanoi City

Factory 1: Hiep Hoa
Industrial Cluster,
BacNinh Province

Factory 2: Thang town,
Hiep Hoa District,
BacNinh Province

Factory 3: Thanhvan
Industrial Cluster,
BacNinh Province

Factory 4: Chung Village,
Hiep Hoa Commune,
BacNinh Province